

Area reinstated with short-flowering wildflower meadow

Three *Sorbus aucuparia* 'Sheerwater Seedling' trees proposed to echo existing avenue in Carlow Town Park

Clearstem tree to demarcate entrance to site and soften parking area

Ornamental grass and perennial planting strip to include specie that support biodiversity to soften scale of hard surfacing in courtyard

Border of short-flowering wildflower meadow to changing room building

Trio of *Betula pubescens* trees proposed to soften space to south of buildings

Reinstate damaged areas by re-seeding with pollinator-friendly wildflower mix designed to be cut 2-3 times annually

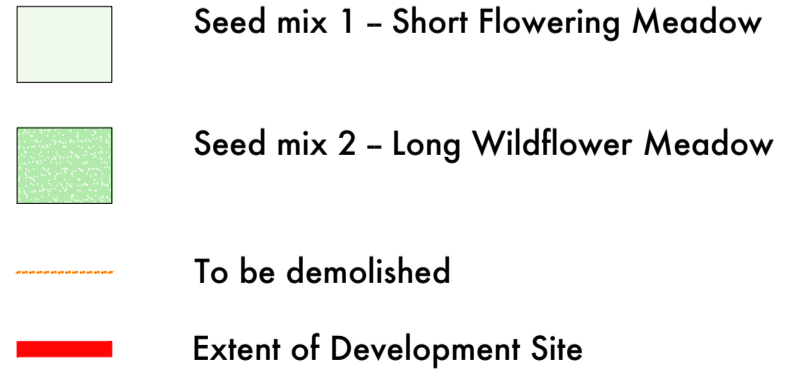
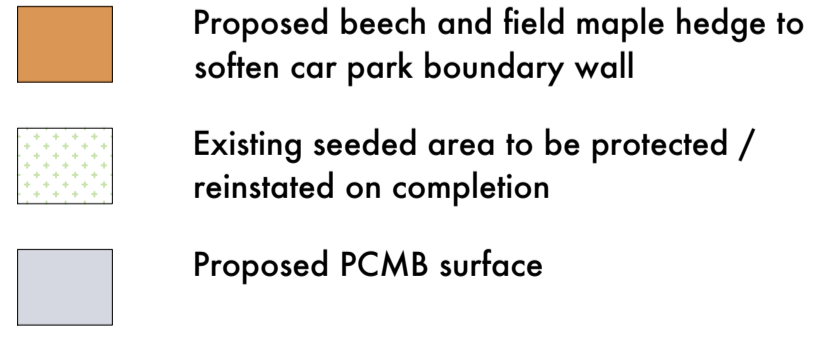
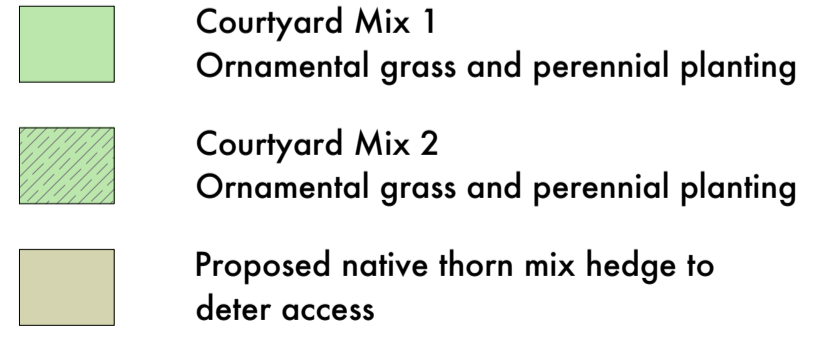
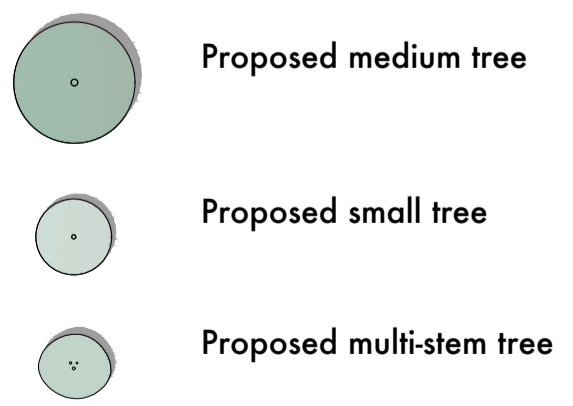
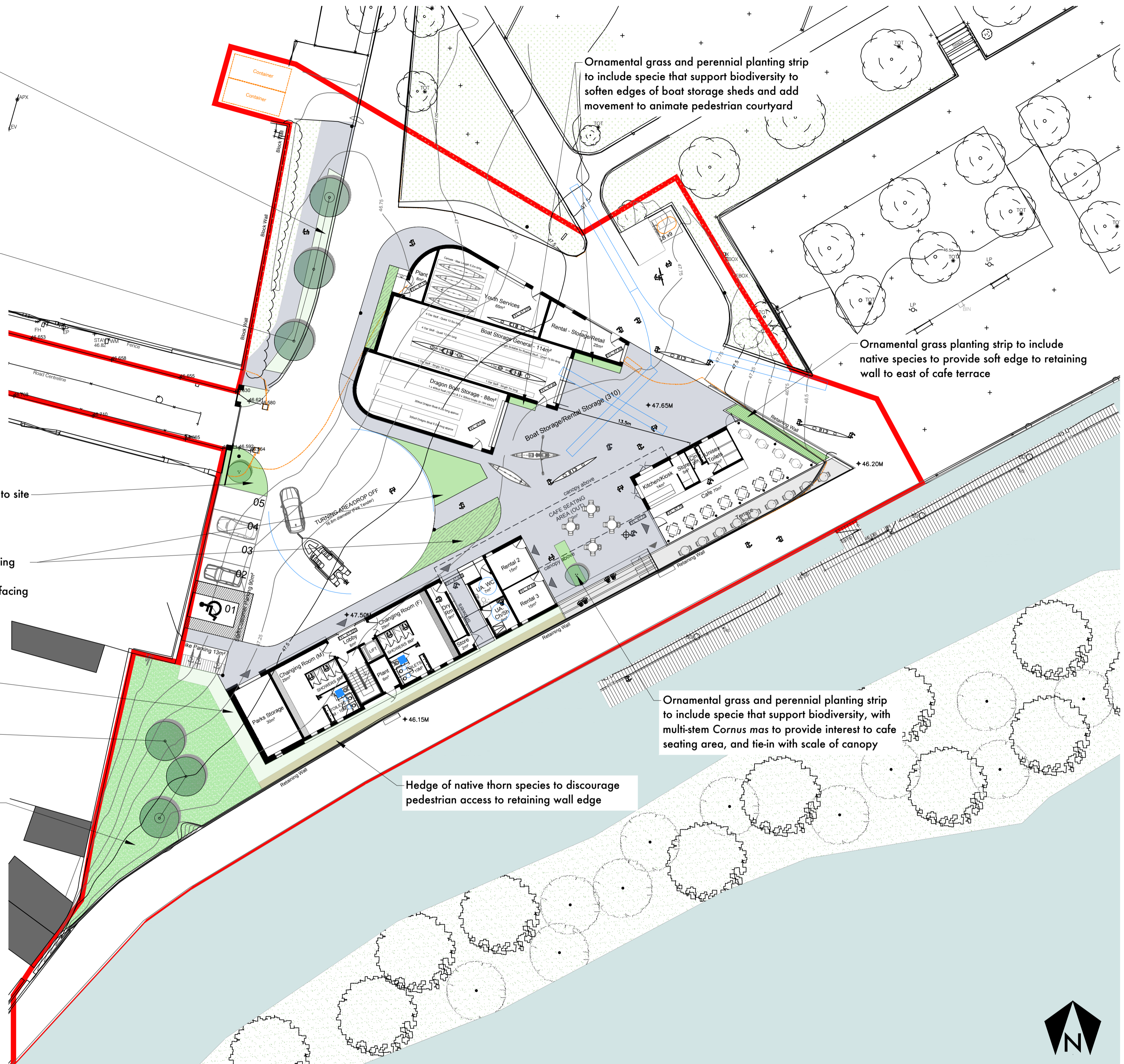

Refer to Planting Schedule for details on planting mixes and specification

© Studio Town Land 2021 This drawing and any design herein is the copyright of Studio Town Land and may not be reproduced, copied or otherwise reproduced in whole or in part or used for any purpose without their written consent. Refer to Landscape Architect immediately for clarification in relation to any discrepancies or omissions.				REV 01 DATE 18/04/21 DESCRIPTION DRAFT FOR DESIGN TEAM REVIEW	DRN LF APD LF	REV 02 DATE 20/04/21 DESCRIPTION DRAFT FOR DESIGN TEAM REVIEW	DRN LF APD LF	REV 03 DATE 27/04/21 DESCRIPTION DRAFT FOR DESIGN TEAM REVIEW	DRN LF APD LF	REV 04 DATE 28/04/21 DESCRIPTION DRAFT FOR DESIGN TEAM REVIEW	DRN LF APD LF	REV 05 DATE 28/04/21 DESCRIPTION DRAFT FOR DESIGN TEAM REVIEW	DRN LF APD LF	STUDIO TOWN LAND Landscape Architecture and Urbanism 8 Marton Street, Clonmel, Co Tipperary, E91 YV20 T 0866049213 E studiotownland@gmail.com	PROJECT TITLE: River Barrow Activity Centre PROJECT LOCATION: Carlow Town Park, Carlow, Co Carlow PROJECT NUMBER: D21004 CLIENT: Carlow County Council	DRAWING TITLE: Proposed Landscape Plan STAGE: DD PROJECT NO: D21004 CONTRACT: 0000 ELEMENT: LS DRAW NO: 0001 DRAW REV: 05 DATE: 28/04/2021 SCALES: 1:250 SHEET SIZE: A1
--	--	--	--	---	------------------	---	------------------	---	------------------	---	------------------	---	------------------	---	---	--

Latin Name	Specification	Container grown = CG Rootball = RB Bare-root = Br	Height at planting cm	Pot Size	Planting density plants / m sq	Percentage of mix %	Area	Quantity (units)	Planting notes
------------	---------------	---	---------------------------------	----------	-----------------------------------	-------------------------------	------	---------------------	----------------

PLANTING BED ORNAMENTAL GRASS AND PERENNIAL MIXES

Courtyard Mix 1

<i>Festuca glauca</i> 'Elijah Blue'	Full pot, Healthy Clump	CG	20-30	C2	4	15	60	36	Plant in groups of 3-5 at edges of planted area
<i>Salvia nemorosa</i> 'Cardonna'	Full pot, Healthy Clump	CG	20-30	p9	4	5	60	12	Plant in groups of 3-5 at edges of planted area
<i>Knautia macedonica</i>	Full pot, Healthy Clump	CG	40-60	C2	4	5	60	12	Plant singly, randomly scattered across area
<i>Verbascum chaixii</i> 'Album'	Full pot, Healthy Clump	CG	40-60	p9	4	5	60	12	Plant singly, randomly scattered across area
<i>Stipa tenuissima</i> 'Ponytails'	Full pot, Healthy Clump	CG	20-30	C2	4	10	60	24	Plant in swathes filling middle of bed
<i>Pennisetum alopecuroides</i> 'Hameln'	Full pot, Healthy Clump	CG	40-60	C2	4	40	60	96	Plant in swathes filling middle of bed
<i>Kniphofia</i> 'Ice Queen'	Full pot, Healthy Clump	CG	40-60	C2	4	5	60	12	Plant in prominent positions to rear of bed
<i>Calamagrostis</i> × <i>acutiflora</i> 'Karl Foerster'	Full pot, Healthy Clump	CG	40-60	C2	4	15	60	36	Plant last to fill spaces to rear of bed
							100	240	

Courtyard Mix 2

							Area			
<i>Persicaria affinis</i> 'Darjeeling Red'	Full pot, Healthy Clump	CG	20-30	C2	10	15	35	53	Plant in groups of 3, filling edges of bed	
<i>Carex comans</i> 'Bronze Form'	Full pot, Healthy Clump	CG	20-30	C2	4	20	35	28	Plant in swathes filling edges of bed	
<i>Acanthus mollis</i>	Full pot, Healthy Clump	CG	20-30	p9	4	5	35	7	Plant singly, in prominent positions	
<i>Molinia caerulea</i> subsp. <i>caerulea</i> 'Moorhexe'	Full pot, Healthy Clump	CG	20-30	C2	4	10	35	14	Plant in swathes	
<i>Carex pendula</i>	Full pot, Healthy Clump	CG	20-30	C2	3	10	35	11	Plant last to fill spaces	
<i>Calamagrostis brachytricha</i>	Full pot, Healthy Clump	CG	20-30	C2	3	40	35	42	Plant in groups in blocks of 5 minimum to centre of bed	
							100	154		

PROPOSED STANDARD TREES, MULTISTEM TREES (CAR-PARK, PARK PATHWAY, CAFÉ TERRACE)

Name	Nursery specification	Form	Breaks	Root system	Height at planting	Quantity	Planting notes
<i>Betula pubescens</i>	3X	HS, Clearstem to 2m	6	Br	3.5-4.25	4	Plant as shown in plan
<i>Cornus mas</i>	3X	Multistem umbrella form	5	Br	1.5-1.75	1	Plant as shown in plan
<i>Sorbus aucuparia</i> 'Sheerwater Seedling'	3X	Clearstem 1.75-2m	5	RB	4-5	3	Plant as shown in plan
						8	

Latin Name	Specification	Container grown = CG Rootball = RB Bare-root = Br	Height at planting cm	Pot Size	Planting density plants / m sq	Percentage of mix %	Area	Quantity (units)	Planting notes
------------	---------------	---	---------------------------------	----------	-----------------------------------	-------------------------------	------	---------------------	----------------

HEDGE A: CLIPPED HEDGE TO CAR PARK BOUNDARY WALL

Latin Name	Nursery Specification / Propagation Method (Seed or Vegetative)	Container grown = CG Rootball = RB Bare-root = Br	Height at planting cm	Pot Size	Planting density plants / m sq	Percentage of mix	Area	Quantity (units)	Planting notes
Acer campestre	1+1	Br	60-90		6	40	44	106	Arrange plants double staggered row to form hedge as shown in plan
Fagus sylvatica	1+2	Br	60-90		6	60	44	158	Arrange plants double staggered row to form hedge as shown in plan

HEDGE B: THORNY HEDGE TO DETER ACCESS

Latin Name	Nursery Specification / Propagation Method (Seed or Vegetative)	Container grown = CG Rootball = RB Bare-root = Br	Height at planting cm	Pot Size	Planting density plants / m sq	Percentage of mix	Area	Quantity (units)	Planting notes
Acer campestre	1+1	Br	60-90		6	20	28	34	Arrange plants double staggered row to form hedge as shown in plan
Crataegus monogyna	1+1	Br	60-90		6	80	28	134	Arrange plants double staggered row to form hedge as shown in plan

Latin Name	Specification	Container grown = CG Rootball = RB Bare-root = Br	Height at planting cm	Pot Size	Planting density plants / m sq	Percentage of mix %	Area	Quantity (units)	Planting notes
------------	---------------	---	---------------------------------	----------	-----------------------------------	-------------------------------	------	---------------------	----------------

SEED MIX 1: SHORT FLOWERING MEADOW

SM1

191 m sq	Grasses	80%							
		Common Bentgrass		Agrostis capillaris		4			
		Brown Bent		Agrostis vinealis		4			
		Meadow Foxtail		Alopecurus Pratensis		1			
		Sweet Vernal Grass		Anthoxanthum Odoratum		1			
		Crested Dogstail		Cynosurus cristatus		23			
		Slender Creeping Red Fescue		Festuca rubra 'Litoralis'		35			
		Chewings Fescue		Festuca rubra spp 'Commut		29			
		Small-leaved Timothy		Phleum bertolonii		2			
		Yellow Oat-grass		Trisetum flavescens		1			
						100			
	Wildflowers	20%							
		Yarrow		Achillea millefolium		2			
		Wild Chamomile		Chamaemelum nobile		2			
		Wild Carrot		Daucus carota		2			
		Lady's Bedstraw		Galium verum		20			
		Birdsfoot trefoil		Lotus corniculatus		18.5			
		Musk Mallow		Malva moschata		1			
		Wild Marjoram		Origanum vulgare		2			
		Ribwort Plantain		Plantago lanceolata		5			
		Selfheal		Prunella vulgaris		20			
		Meadow Buttercup		Ranunculus acris		17.5			
		Common sorrel		Rumex acetosa		5			
		Devil's-bit Scabious		Succisa pratensis		2			
		Red Clover		Trifolium pratense		1			
		Common Vetch		Vicia cracca		2			
						100			

Latin Name	Specification	Container grown = CG Rootball = RB Bare-root = Br	Height at planting cm	Pot Size	Planting density plants / m sq	Percentage of mix %	Area	Quantity (units)	Planting notes
------------	---------------	---	---------------------------------	----------	-----------------------------------	-------------------------------	------	---------------------	----------------

SEED MIX 2: LONG WILDFLOWER MEADOW

SM2

243 sq m

Category	Percentage	Common Name	Latin Name	Quantity
Grasses	80%	Common Bent	<i>Agrostis capillaris</i>	10
		Crested Dogstail	<i>Cynosurus cristatus</i>	35
		Slender-creeping Red-fescue	<i>Festuca rubra</i>	30
		Smaller Cat's-tail	<i>Phleum bertolonii</i>	5
		Smooth-stalked Meadow-grass	<i>Poa pratensis</i>	20
Wildflowers	20%	Yarrow	<i>Achillea millefolium</i>	8
		Lesser Knapweed	<i>Centaurea nigra</i>	12.5
		Wild Carrot	<i>Daucus carota</i>	15
		Lady's Bedstraw	<i>Galium verum</i>	15
		Oxeye Daisy	<i>Leucanthemum vulgare</i>	12.5
		Birdsfoot trefoil	<i>Lotus corniculatus</i>	2
		Wild marjoram	<i>Origanum vulgare</i>	4
		Ribwort Plantain	<i>Plantago lanceolata</i>	5
		Selfheal	<i>Prunella vulgaris</i>	1.5
		Yellow Rattle	<i>Rhinanthus Minor</i>	6
		Red Campion	<i>Silene dioica</i>	5
		Devil's-bit Scabious	<i>Succisa pratensis</i>	12.5
		Red Clover	<i>Trifolium pratense</i>	1
			<u>100</u>	