 <p>DRA CONSULTING ENGINEERS</p>	<p>Limerick The Park Lord Edward Street Limerick V94 840C Tel 061 310701</p>	<p>Wexford 14 Crescent Mall Henrietta Street Wexford Y35 XD1K Tel 053 9152814</p>	<p>Dublin 30 Drumcondra Rd Upper Drumcondra Dublin 9 D09 FT7K Tel 01 2162956</p>	<p>Project No.: K194</p>	<p>Pages: 1 of 1</p>													
	<p>Project Title: River Barrow Activity Centre</p>			<p>Client: Carlow County Council</p>														
	<p>Doc Control:</p>	<p>Producer</p>	<p>Reviewer</p>	<p>Approver</p>	<p>Issue Date</p>													
<p>Name:</p>	RK	KD	BH	29-Apr-2021	22-Sep-2021	23-Sep-2021												
<p>Date:</p>	29/04/2021	29/04/2021	29/04/2021															

Drawing Title	Drawing No.	Revisions																
Existing Site Plan	K194-100	1	2															
Proposed Drainage Layout	K194-150	1	2															
Proposed Watermain Layout	K194-160	1	2															
Proposed Road Layout	K194-170	1	2															
Proposed Vehicle Swept Path	K194-175	1	2															

Document Title	Document No.	Revisions																
Flood Risk Assessment		1	2															
Civil Engineering Planning Report		1		2														

Distributed to	Number of Copies																	
Project Manager:																		
Architect: KHA	E	E	E															
Services Consultant:																		
Quantity Surveyor:																		
Planning Authority:																		
Client:																		
Irish Water:																		
Purpose of Issue	P	P	P															

D = Draft, P = Planning, C = Construction, T = Tender, CT = Contract, R = Record
 Note: For non-paper issue insert, M = media issue (CD/Zip Drive etc) or E = e-mail issue, against Number of Copies.

COPYRIGHT AND OWNERSHIP OF THIS DRAWING IS VESTED IN DRA CONSULTING ENGINEERS. NO PART OF THIS DOCUMENT MAY BE REPRODUCED OR TRANSMITTED IN ANY FORM OR STORED IN ANY RETRIEVAL SYSTEM OF ANY NATURE WITHOUT THE WRITTEN PERMISSION OF DRA CONSULTING ENGINEERS AS COPYRIGHT HOLDER EXCEPT AS AGREED FOR USE ON THE PROJECT FOR WHICH THE DOCUMENT WAS ORIGINALLY ISSUED. ©

ALL RIGHTS RESERVED BY THE LAW OF COPYRIGHT AND BY INTERNATIONAL COPYRIGHT CONVENTIONS ARE RESERVED TO DRA CONSULTING ENGINEERS. ©

ORDNANCE SURVEY MAPS REPRODUCED UNDER LICENCE No. CYAL50173115. © ORDNANCE SURVEY IRELAND / GOVERNMENT OF IRELAND.

- NOTES:
1. ALL DIMENSIONS ARE IN MILLIMETRES AND LEVELS IN METRES UNLESS NOTED OTHERWISE.
 2. USE FIGURED DIMENSIONS ONLY. DO NOT SCALE.
 3. DRAWINGS TO BE READ IN CONJUNCTION WITH ALL RELEVANT ENGINEER'S, ARCHITECT'S AND SERVICE ENGINEER'S DRAWINGS AND SPECIFICATIONS.
 4. ALL WORKS TO BE CARRIED OUT IN ACCORDANCE WITH CURRENT BUILDING REGULATIONS.

LEGEND:

- SITE BOUNDARY
- 6m WIDE EASEMENT
- - - EXISTING SURFACE WATER
- RG EXISTING ROAD GULLY
- - - EXISTING COMBINED OVERFLOW SEWER
- - - EXISTING COMBINED SEWER
- - - EXISTING WATERMAIN
- - - EXISTING GAS NETWORK

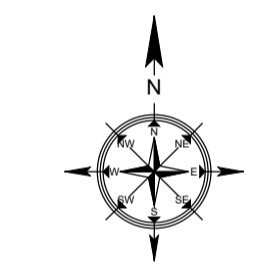

ORDNANCE SURVEY IRELAND LICENCE No. EN 0057221 © ORDNANCE SURVEY IRELAND / GOVERNMENT OF IRELAND

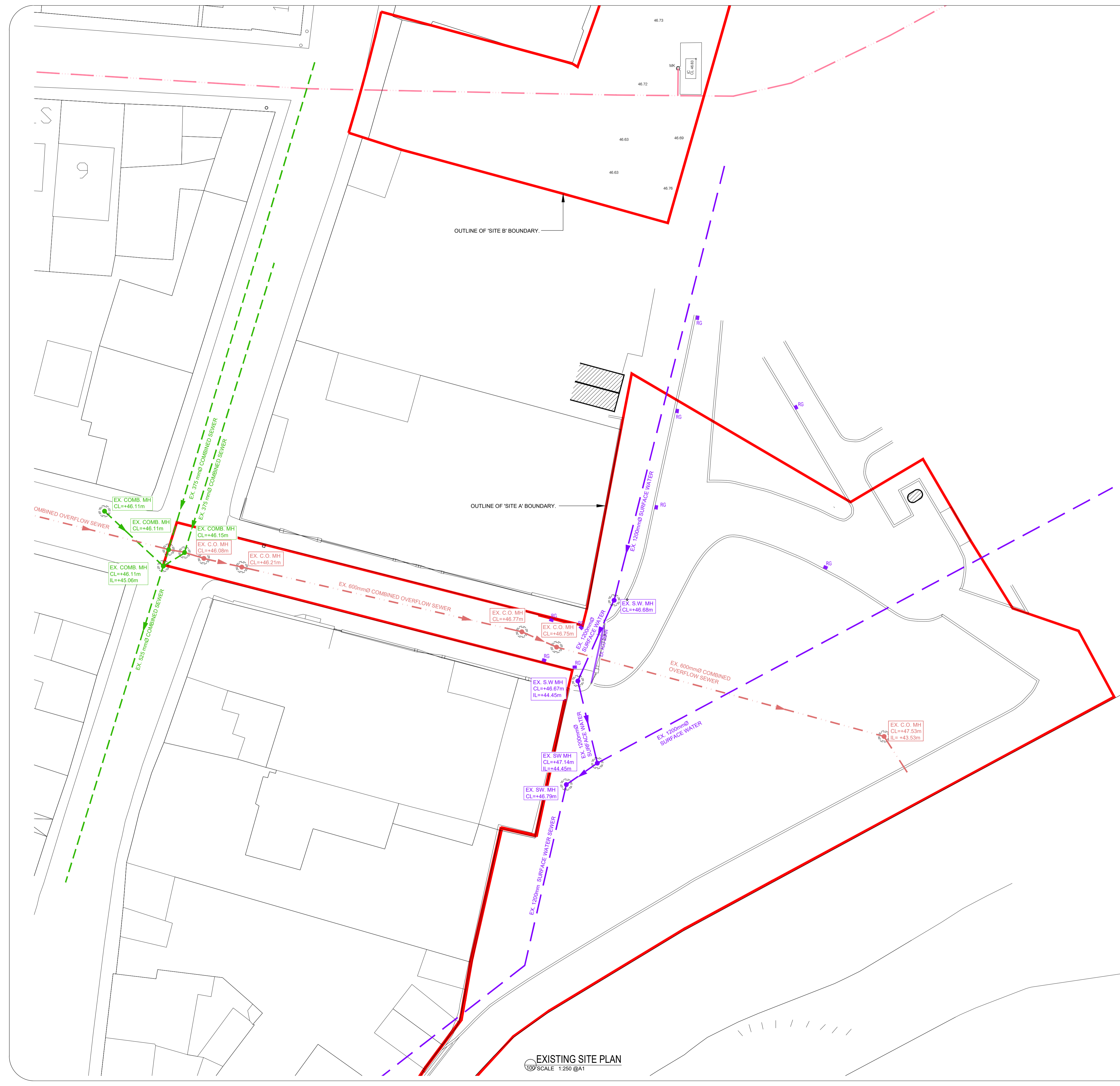

EXISTING SITE PLAN SCALE 1:250 @A1

2.	PLANNING ISSUE	R.K.	K.D.	B.H.	23.09.2021
REV.	DESCRIPTION	PROD.	VERIF.	APPR.	DATE

PLANNING

DRA
CONSULTING ENGINEERS

NSAI

DUBLIN T: 01-216-2956 LIMERICK 061-310-701 WEXFORD 053-915-2814 E: info@draconsulting.ie W: www.draconsulting.ie

ARCHITECT: CARLOW COUNTY COUNCIL

PROJECT: RIVER BARROW ACTIVITY CENTRE, THE PARK CARLOW, Co.CARLOW

TITLE: EXISTING SITE PLAN

DATE:	29/04/2021	SCALE:	1:300 @ A1
DESIGNER:	RK	ORG. No.	
PRODUCER:	RK		
VERIFIER:	KD	K194-100	2
APPROVER:	BH		

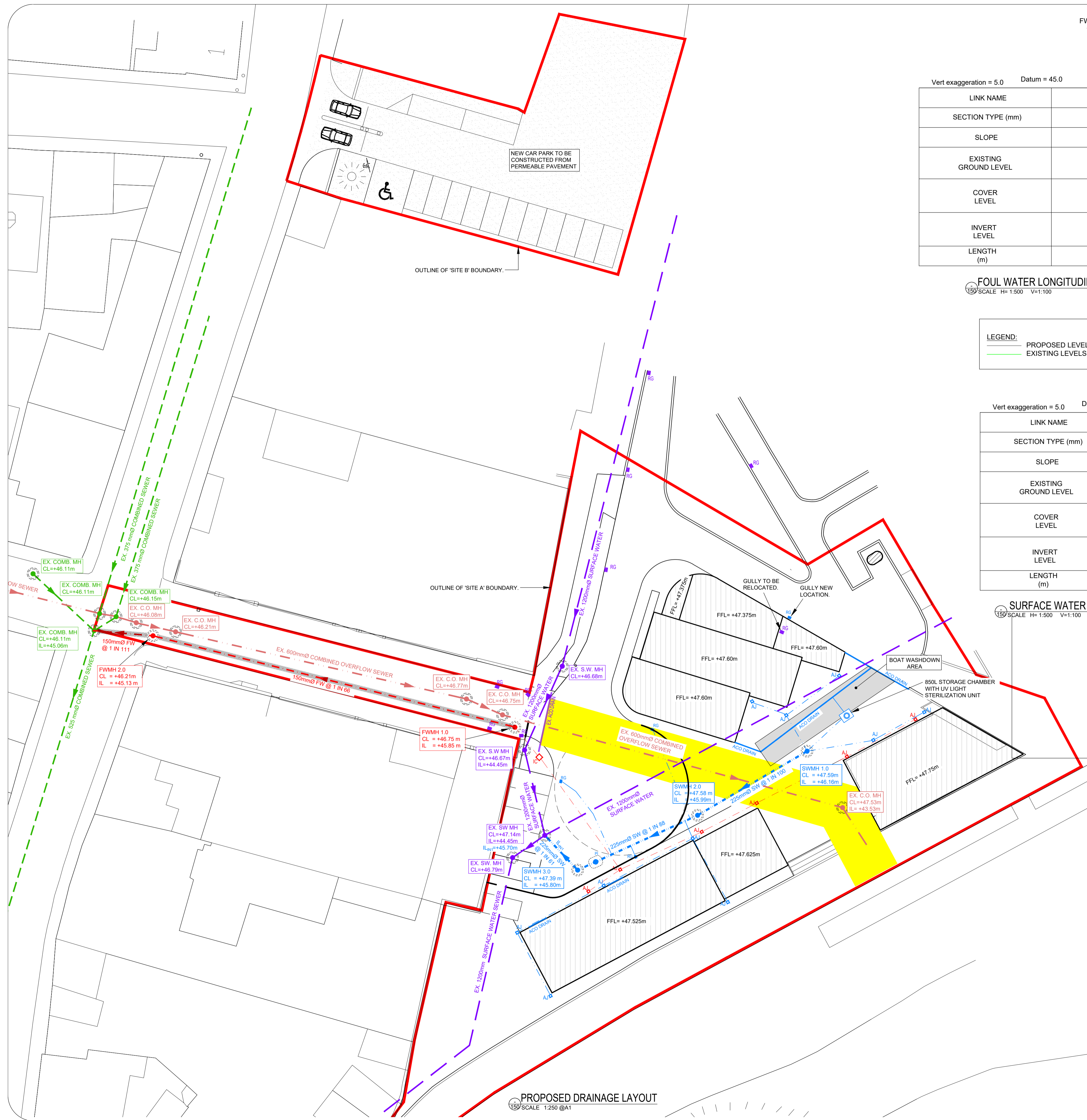

PROPOSED DRAINAGE LAYOUT
SCALE: 1:250 @A1

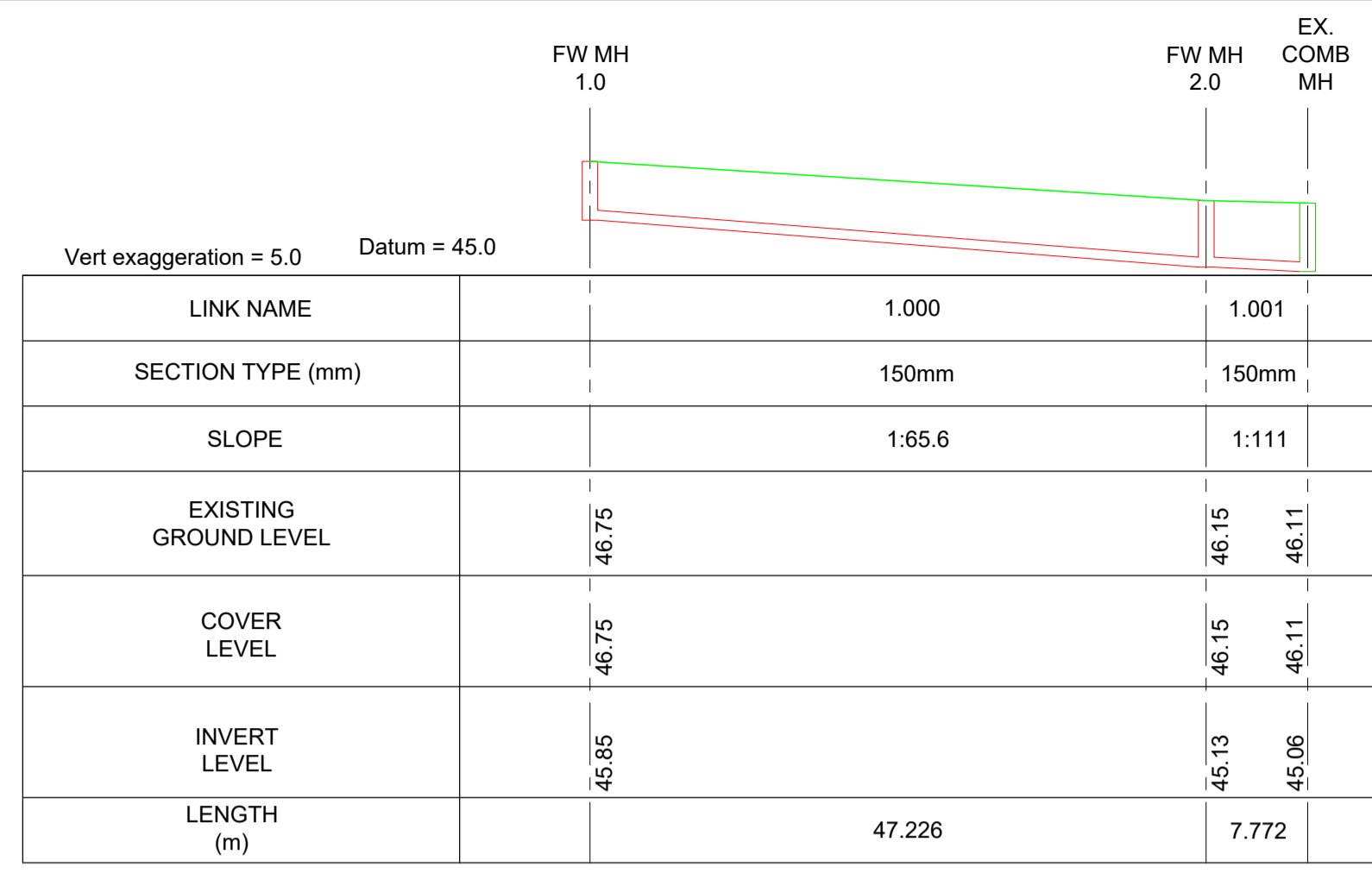

FOUL WATER LONGITUDINAL SECTION- FOUL MH 1.0 TO EX.COMB.MH
SCALE: H=1:500 V=1:100

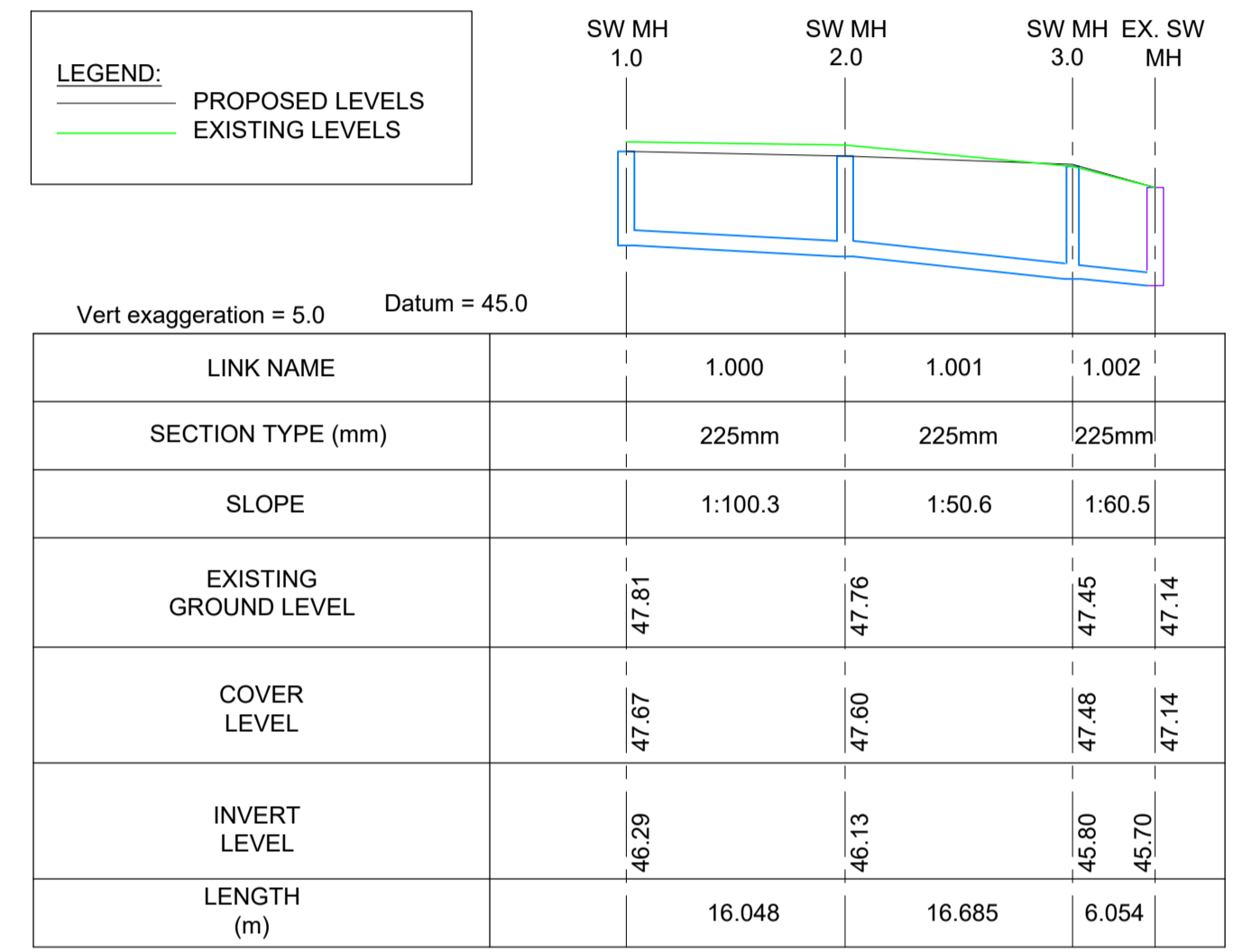

SURFACE WATER LONGITUDINAL SECTION- SW MH 1.0 TO EX.SW.MH
SCALE: H=1:500 V=1:100

COPYRIGHT AND OWNERSHIP OF THIS DRAWING IS VESTED IN DENNANY REIDY ASSOCIATES LTD. NO PART OF THIS DOCUMENT MAY BE REPRODUCED OR TRANSMITTED IN ANY FORM OR STORED IN ANY RETRIEVAL SYSTEM OF ANY NATURE WITHOUT THE WRITTEN PERMISSION OF DENNANY REIDY ASSOCIATES AS COPYRIGHT HOLDER EXCEPT AS AGREED FOR USE ON THE PROJECT FOR WHICH THE DOCUMENT WAS ORIGINALLY ISSUED. ©
ALL RIGHT RESERVED BY THE LAW OF COPYRIGHT AND BY INTERNATIONAL COPYRIGHT CONVENTIONS ARE RESERVED TO DENNANY REIDY ASSOCIATES LTD. ©

- NOTES:
- ALL DIMENSIONS ARE IN MILLIMETRES AND LEVELS IN METRES UNLESS NOTED OTHERWISE.
 - USE FIGURED DIMENSIONS ONLY. DO NOT SCALE.
 - DRAWINGS TO BE READ IN CONJUNCTION WITH ALL RELEVANT ENGINEER'S, ARCHITECTS AND SERVICE ENGINEER'S DRAWINGS AND SPECIFICATIONS.
 - ALL WORKS TO BE CARRIED OUT IN ACCORDANCE WITH CURRENT BUILDING REGULATIONS.

LEGEND:

- APPLICATION OUTLINE
- EXISTING SURFACE WATER SEWER
- EXISTING ROAD GULLY
- EXISTING COMBINED SEWER
- PROPOSED SURFACE WATER SEWER
- PROPOSED SURFACE WATER INSPECTION CHAMBER AS PER PART H (600-1000mm DEEP @450mm)
- PROPOSED SURFACE WATER AJ AS PER PART H (400-600mm DEEP, @300mm)
- PROPOSED ROAD GULLY
- ACO CHANNEL
- 1000 PRIVATE SW @ MINIMUM 1:100
- PETROL INTERCEPTOR
- EXISTING COMBINED OVERFLOW SEWER
- PROPOSED FOUL SEWER
- ENCASED IN CONCRETE
- PROPOSED FOUL INSPECTION CHAMBER AS PER IW DETAIL STD-WW-13 (CIRCA 900mm DEEP)
- PROPOSED FOUL INSPECTION CHAMBER AS PER PART H (600-1000mm DEEP, @450mm)
- PROPOSED FOUL AJ AS PER PART H (400-600mm DEEP, @300mm)
- 1000 PRIVATE FOUL @ MINIMUM 1:60
- 6m WIDE EASEMENT
- NEW PERMEABLE PAVING AS PER MANUFACTURER SPECIFICATIONS.

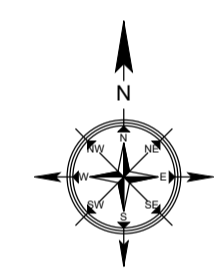

ORDNANCE SURVEY IRELAND LICENCE No. EN 0057221
© ORDNANCE SURVEY IRELAND / GOVERNMENT OF IRELAND

IRISH WATER STANDARD DETAILS AND CODE PRACTICE (FOUL DRAINAGE):
ALL OF THE UNDERGROUND FOUL DRAINAGE WORKS, FROM THE PUBLIC SIDE INSPECTION CHAMBER TO NEW CONNECTION TO EXISTING PUBLIC MANHOLE, SHOULD BE CARRIED OUT IN ACCORDANCE WITH IRISH WATER'S (IW) 'WASTEWATER INFRASTRUCTURE STANDARD DETAILS' AND 'CODE OF PRACTICE FOR WASTEWATER INFRASTRUCTURE'.

PIPE MATERIALS:
1. SERVICE CONNECTIONS FROM DWELLINGS TO BE 100mm Ø UNPLASTICISED PVC IN ACCORDANCE WITH SECTION 3.13 OF IW CODE OF PRACTICE.
2. FOUL SEWERS TO BE IN ACCORDANCE WITH SECTION 3.13 OF THE IW CODE OF PRACTICE.

TESTING:
1. FOUL SEWER AND MANHOLES TO BE TESTED IN ACCORDANCE WITH SECTION 4.10 OF IW CODE OF PRACTICE.
2. CCTV AND MANHOLE CONDITION SURVEYS TO BE CARRIED OUT IN ACCORDANCE WITH SECTION 1.9 OF IW CODE OF PRACTICE IN ADVANCE OF THE DEFECTS LIABILITY PERIOD.

IRISH WATER INSPECTIONS & AS-BUILTS:
1. CONTRACTOR TO ENSURE THAT IW FIELD ENGINEERS INSPECT WORKS IN ACCORDANCE WITH THE QUALITY ASSURANCE (QA) FIELD INSPECTION REQUIREMENTS MANUAL.
2. CONTRACTOR TO ENSURE THAT AS CONSTRUCTED ELEMENTS ARE ADEQUATELY SURVEYED PRIOR TO COVERING UP TO ENSURE AS-BUILT DRAWINGS IN ACCORDANCE WITH QUALITY ASSURANCE (QA) FIELD INSPECTION REQUIREMENTS MANUAL CAN BE PRODUCED ON COMPLETION OF WORK.

CONSTRUCTION DETAILS:
ALL SITE WATER SERVICES TO BE IN ACCORDANCE WITH CURRENT IRISH WATER INFRASTRUCTURE STANDARD DETAILS REFER TO IRISH WATER STANDARD DETAILS. DOCUMENT No. IW-CDS-5030-01

TECHNICAL GUIDANCE DOCUMENT PART H (SURFACE WATER & PRIVATE FOUL DRAINAGE):
ALL PRIVATE FOUL DRAINAGE UPSTREAM OF THE IRISH WATER PRIVATE SIDE INSPECTION CHAMBER AND ALL OF THE SURFACE WATER DRAINAGE SHOULD BE CARRIED OUT IN ACCORDANCE WITH PART H - DRAINAGE & THE GREATER DUBLIN REGIONAL CODE OF PRACTICE FOR DRAINAGE WORKS.

MATERIALS:
1. ALL UNDERGROUND PIPEWORK TO BE IN ACCORDANCE WITH TABLE 7 OF PART H & SECTION 11 OF THE GREATER DUBLIN REGIONAL CODE OF PRACTICE FOR DRAINAGE WORKS.

MANHOLES:
1. ALL SURFACE WATER MANHOLES TO BE CONSTRUCTED IN ACCORDANCE WITH SECTION 9 OF THE GREATER DUBLIN REGIONAL CODE OF PRACTICE FOR DRAINAGE WORKS.

BEDDING:
1. ALL UNDERGROUND PIPEWORK TO BE IN ACCORDANCE WITH DIAGRAM 8 OF PART H & SECTION 11 OF THE GREATER DUBLIN REGIONAL CODE OF PRACTICE FOR DRAINAGE WORKS.

TESTING:
1. TESTING TO BE IN ACCORDANCE WITH SECTION 12 OF THE GREATER DUBLIN REGIONAL CODE OF PRACTICE FOR DRAINAGE WORKS.
2. ALL EXISTING SEWERS WITHIN THE SITE'S BOUNDARY SHOULD BE CCTV SURVEYED PRIOR TO COMMENCEMENT OF WORKS.
3. ALL NEW DRAINAGE SHOULD BE CCTV SURVEYED ON COMPLETION OF WORKS.

2.	PLANNING ISSUE	R.K.	K.D.	B.H.	23.09.2021
REV.	DESCRIPTION	PROD.	VERIF.	APPR.	DATE

PLANNING

DRA
CONSULTING ENGINEERS

NSAI
MEMBER

DUBLIN | LIMERICK | WEXFORD | E: info@draconsulting.ie
T: 01-216-2956 | 061-310-701 | 053-915-2814 | W: www.draconsulting.ie

CLIENT: CARLOW COUNTY COUNCIL

PROJECT: RIVER BARROW ACTIVITY CENTRE, THE PARK, CARLOW, Co. CARLOW

TITLE: PROPOSED DRAINAGE LAYOUT

DATE:	29/04/2021	SCALE:	AS SHOWN @ A1
DESIGNER:	RK	DRG. No.	
PRODUCER:	RK		
VERIFIER:	KD	K194-150	
APPROVER:	BH		

REV. **2**

COPYRIGHT AND OWNERSHIP OF THIS DRAWING IS VESTED IN DENNANY REIDY ASSOCIATES LTD. NO PART OF THIS DOCUMENT MAY BE REPRODUCED OR TRANSMITTED IN ANY FORM OR STORED IN ANY RETRIEVAL SYSTEM OF ANY NATURE WITHOUT THE WRITTEN PERMISSION OF DENNANY REIDY ASSOCIATES AS COPYRIGHT HOLDER EXCEPT AS AGREED FOR USE ON THE PROJECT FOR WHICH THE DOCUMENT WAS ORIGINALLY ISSUED. ©
 ALL RIGHT RESERVED BY THE LAW OF COPYRIGHT AND BY INTERNATIONAL COPYRIGHT CONVENTIONS ARE RESERVED TO DENNANY REIDY ASSOCIATES LTD. ©

- NOTES:**
1. ALL DIMENSIONS ARE IN MILLIMETRES AND LEVELS IN METRES UNLESS NOTED OTHERWISE.
 2. USE FIGURED DIMENSIONS ONLY. DO NOT SCALE.
 3. DRAWINGS TO BE READ IN CONJUNCTION WITH ALL RELEVANT ENGINEER'S, ARCHITECTS AND SERVICE ENGINEER'S DRAWINGS AND SPECIFICATIONS.
 4. ALL WORKS TO BE CARRIED OUT IN ACCORDANCE WITH CURRENT BUILDING REGULATIONS.

LEGEND:

- APPLICATION OUTLINE
- EXISTING WATERMAIN
- PROPOSED WATERMAIN (1000 PE)
- PROPOSED SERVICE CONNECTION (250 PE)
- PROPOSED SLUICE VALVE
- PROPOSED SCOUR VALVE
- PROPOSED AIR VALVE
- PROPOSED HYDRANT
- PROPOSED WASHOUT HYDRANT
- PROPOSED WATERMETER
- 6m WIDE EASEMENT

IRISH WATER STANDARD DETAILS AND CODE PRACTICE:
 ALL OF THE SITE WATERMAIN WORKS SHOULD BE CARRIED OUT IN ACCORDANCE WITH IRISH WATERS (IW) "WATER INFRASTRUCTURE STANDARD DETAILS" AND "CODE OF PRACTICE FOR WATER INFRASTRUCTURE".

- MATERIALS:**
1. ALL WATERMAIN PIPE MATERIALS TO BE IN ACCORDANCE WITH SECTION 3.9 OF THE CODE OF PRACTICE.
 2. HYDRANTS TO COMPLY WITH BS 750, TYPE 2 SCREW DOWN TYPE & IRISH WATER CODE OF PRACTICE.
 3. HYDRANT INDICATOR PLATES TO COMPLY WITH BS 3251 & IRISH WATER CODE OF PRACTICE.

- TESTING:**
1. ALL ELEMENTS TO BE TESTED IN ACCORDANCE WITH SECTION 4.10 OF IW CODE OF PRACTICE.

- IRISH WATER INSPECTIONS & AS-BUILTS:**
1. CONTRACTOR TO ENSURE THAT IW FIELD ENGINEERS INSPECTS WORKS IN ACCORDANCE WITH QUALITY ASSURANCE (QA) FIELD INSPECTION REQUIREMENTS MANUAL.
 2. CONTRACTOR TO ENSURE THAT AS CONSTRUCTED ELEMENTS ARE ADEQUATELY SURVEYED PRIOR TO COVERING UP TO ENSURE AS-BUILT DRAWINGS IN ACCORDANCE WITH QUALITY ASSURANCE (QA) FIELD INSPECTION REQUIREMENTS MANUAL CAN BE PRODUCED ON COMPLETION OF WORK.

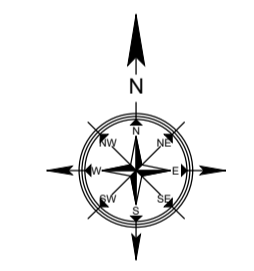

ORDNANCE SURVEY IRELAND LICENCE No. EN 0057221
 © ORDNANCE SURVEY IRELAND / GOVERNMENT OF IRELAND

2.	PLANNING ISSUE	R.K.	K.D.	B.H.	23.09.2021
REV.	DESCRIPTION	PROD.	VERIF.	APPR.	DATE

PLANNING

DRA
 CONSULTING ENGINEERS

NSAI

DUBLIN T: 01-216-2956 | LIMERICK 061-310-701 | WEXFORD 053-915-2814 | E: info@draconsulting.ie | W: www.draconsulting.ie

CLIENT: CARLOW COUNTY COUNCIL

PROJECT: RIVER BARROW ACTIVITY CENTRE, THE PARK, CARLOW, Co. CARLOW

TITLE: PROPOSED WATERMAIN LAYOUT

DATE:	29/04/2021	SCALE:	1:250 @ A1
DESIGNER:	RK	DRG. No.	
PRODUCER:	RK		
VERIFIER:	KD	K194-160	
APPROVER:	BH		2

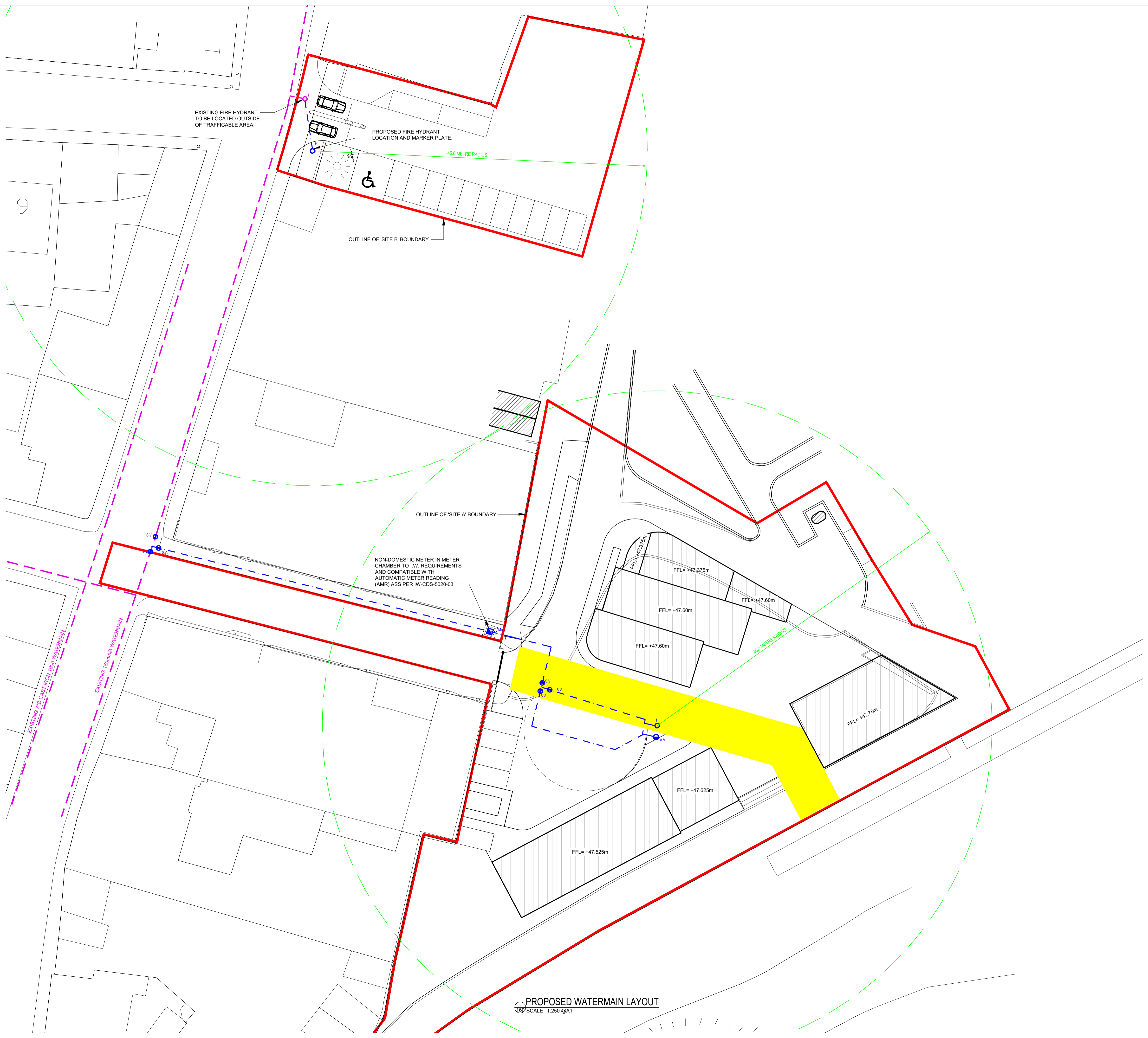

COPYRIGHT AND OWNERSHIP OF THIS DRAWING IS VESTED IN DENNANY REIDY ASSOCIATES LTD. NO PART OF THIS DOCUMENT MAY BE REPRODUCED OR TRANSMITTED IN ANY FORM OR STORED IN ANY RETRIEVAL SYSTEM OF ANY NATURE WITHOUT THE WRITTEN PERMISSION OF DENNANY REIDY ASSOCIATES AS COPYRIGHT HOLDER EXCEPT AS AGREED FOR USE ON THE PROJECT FOR WHICH THE DOCUMENT WAS ORIGINALLY ISSUED. ©

ALL RIGHT RESERVED BY THE LAW OF COPYRIGHT AND BY INTERNATIONAL COPYRIGHT CONVENTIONS ARE RESERVED TO DENNANY REIDY ASSOCIATES LTD. ©

- NOTES:
1. ALL DIMENSIONS ARE IN MILLIMETRES AND LEVELS IN METRES UNLESS NOTED OTHERWISE.
 2. USE FIGURED DIMENSIONS ONLY. DO NOT SCALE.
 3. DRAWINGS TO BE READ IN CONJUNCTION WITH ALL RELEVANT ENGINEER'S, ARCHITECTS AND SERVICE ENGINEER'S DRAWINGS AND SPECIFICATIONS.
 4. ALL WORKS TO BE CARRIED OUT IN ACCORDANCE WITH CURRENT BUILDING REGULATIONS AND RELEVANT CODES OF PRACTICE.
 5. KERBS, FOOTWAYS AND PAVED AREAS TO BE IN ACCORDANCE WITH TII PUBLICATIONS FOOTWAY DESIGN & VOLUME 1 SPECIFICATION FOR ROAD WORKS SERIES 1100 KERBS, FOOTWAYS AND PAVED AREAS.
 6. DISHING OF FOOTPATHS WITH INCLUSION OF TACTILE PAVING TO BE CONSTRUCTED IN ACCORDANCE WITH GUIDANCE ON THE USE OF TACTILE PAVING SURFACES DOCUMENT.

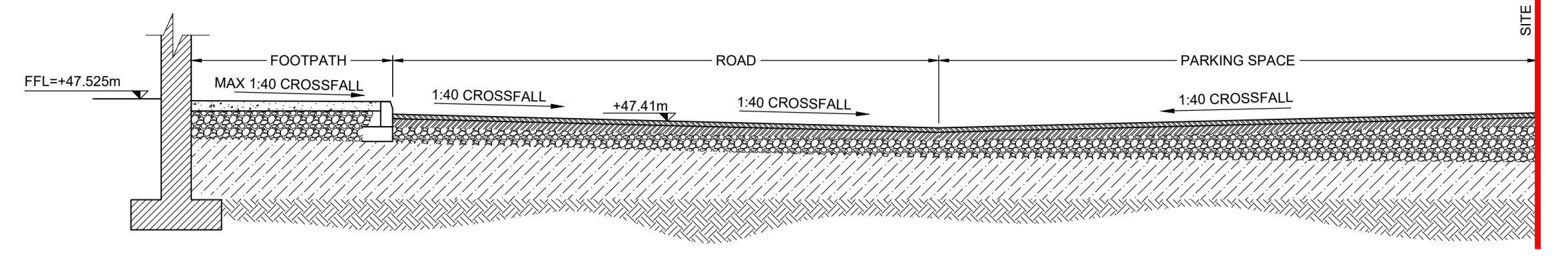
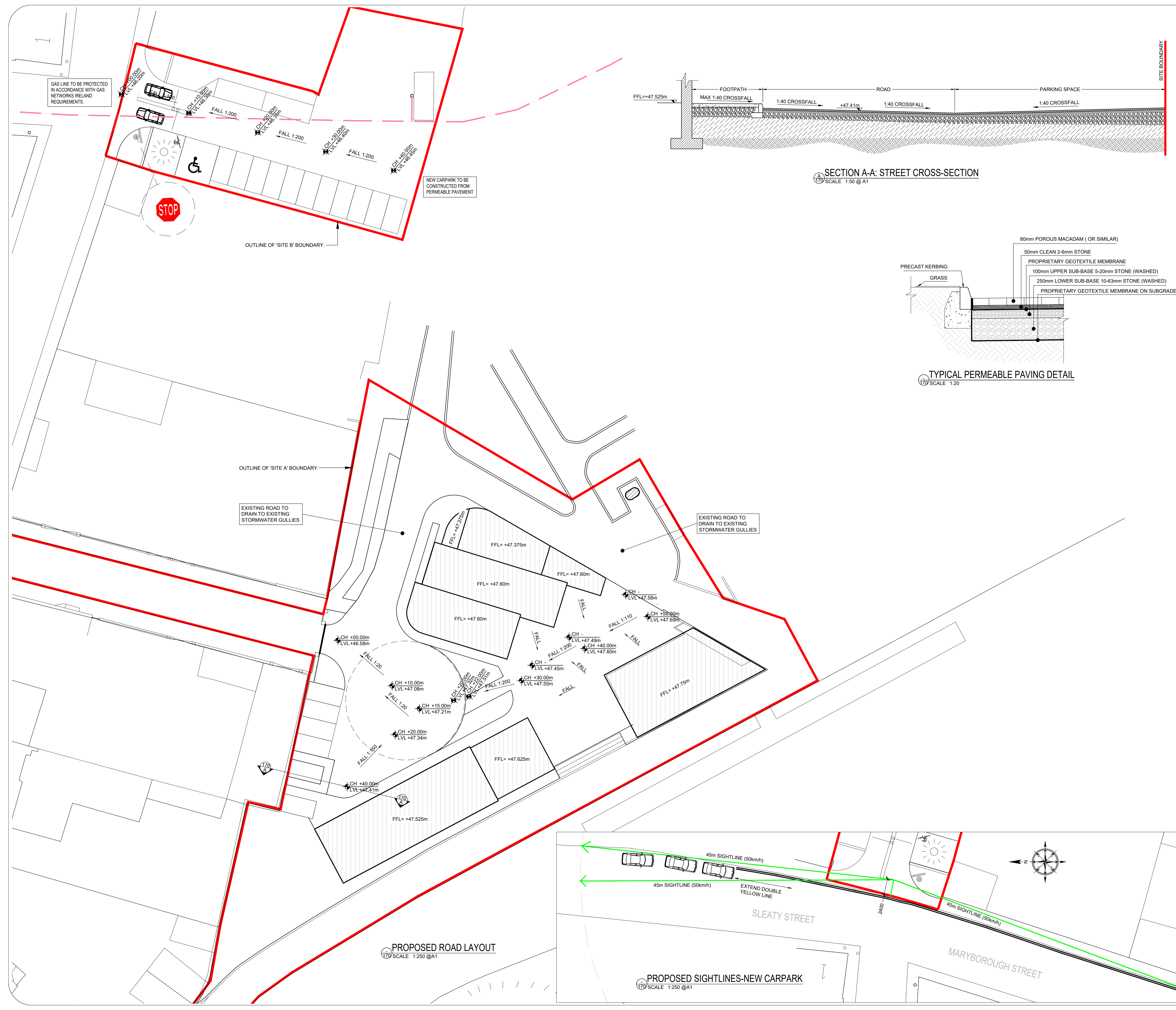

SECTION A-A: STREET CROSS-SECTION
SCALE 1:50 @ A1

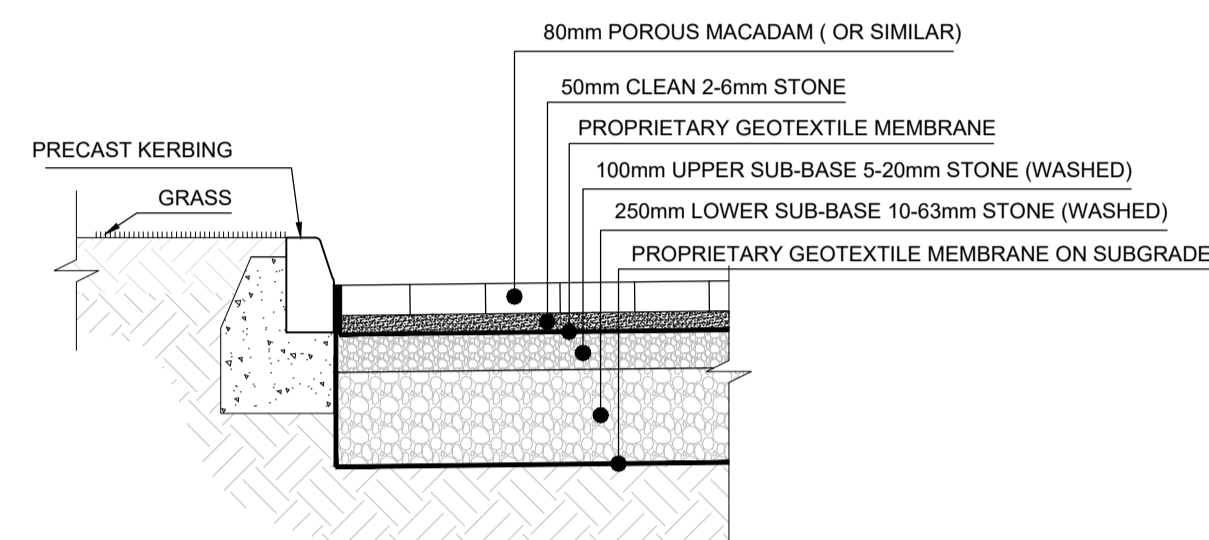

TYPICAL PERMEABLE PAVING DETAIL
SCALE 1:20

LEGEND:

- SITE BOUNDARY
- EXISTING GAS NETWORK
- CH +90.00m / LVL +7.60m DENOTES CHAINAGE DISTANCE & PROPOSED ROAD LEVEL
- FALL 1:125 ROAD LONGITUDINAL GRADIENT
- SIGNAGE: (RUS 027) STOP SIGN

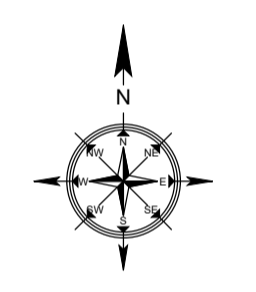

ORDNANCE SURVEY IRELAND LICENCE No. EN 0057221
© ORDNANCE SURVEY IRELAND / GOVERNMENT OF IRELAND

NOTE: SIGHT LINES IN ACCORDANCE WITH TABLE 4.2: REDUCED SSD STANDARDS FOR APPLICATION WITHIN CITIES TOWNS AND VILLAGES 1 DESIGN MANUAL FOR URBAN ROADS AND STREETS.

2.	PLANNING ISSUE	R.K.	K.D.	B.H.	23.09.2021
REV.	DESCRIPTION	PROD.	VERIF.	APPR.	DATE

PLANNING

DRA
CONSULTING ENGINEERS

NSAI

DUBLIN T: 01-216-2956 | LIMERICK 061-310-701 | WEXFORD 053-915-2814 | E: info@draconsulting.ie | W: www.draconsulting.ie

CLIENT: CARLOW COUNTY COUNCIL

PROJECT: RIVER BARROW ACTIVITY CENTRE, THE PARK, CARLOW, Co. CARLOW

TITLE: PROPOSED ROAD LAYOUT & SIGHTLINES

DATE:	29/04/2021	SCALES:	AS SHOWN @ A1
DESIGNER:	RK	DRG. No.	
PRODUCER:	RK		
VERIFIER:	KD	K194-170	
APPROVER:	BH		2

PROPOSED ROAD LAYOUT
SCALE 1:250 @ A1

PROPOSED SIGHTLINES-NEW CARPARK
SCALE 1:250 @ A1

COPYRIGHT AND OWNERSHIP OF THIS DRAWING IS VESTED IN DENNANY REIDY ASSOCIATES LTD. NO PART OF THIS DOCUMENT MAY BE REPRODUCED OR TRANSMITTED IN ANY FORM OR STORED IN ANY RETRIEVAL SYSTEM OF ANY NATURE WITHOUT THE WRITTEN PERMISSION OF DENNANY REIDY ASSOCIATES AS COPYRIGHT HOLDER EXCEPT AS AGREED FOR USE ON THE PROJECT FOR WHICH THE DOCUMENT WAS ORIGINALLY ISSUED. ©

ALL RIGHTS RESERVED BY THE LAW OF COPYRIGHT AND BY INTERNATIONAL COPYRIGHT CONVENTIONS ARE RESERVED TO DENNANY REIDY ASSOCIATES LTD. ©

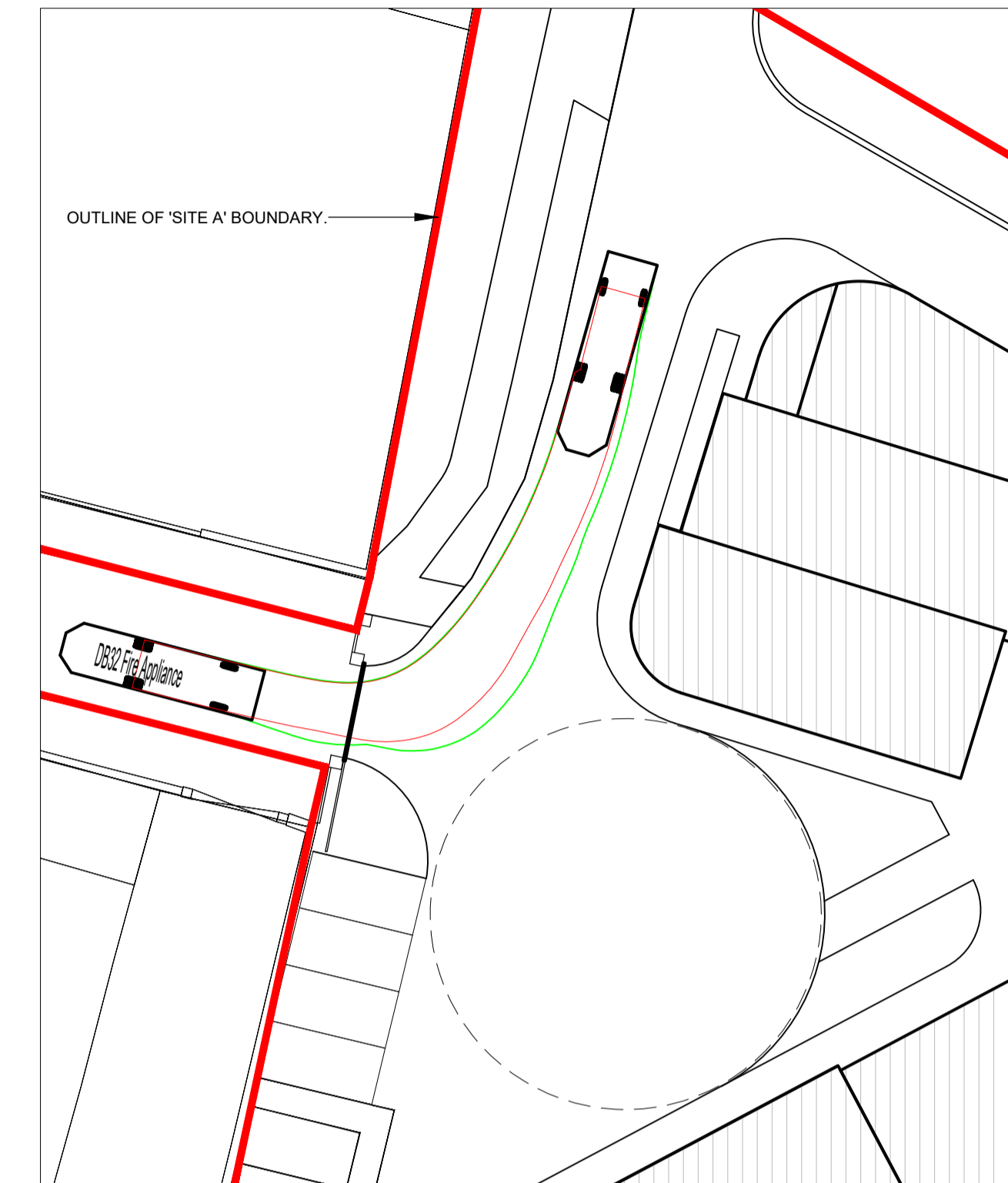
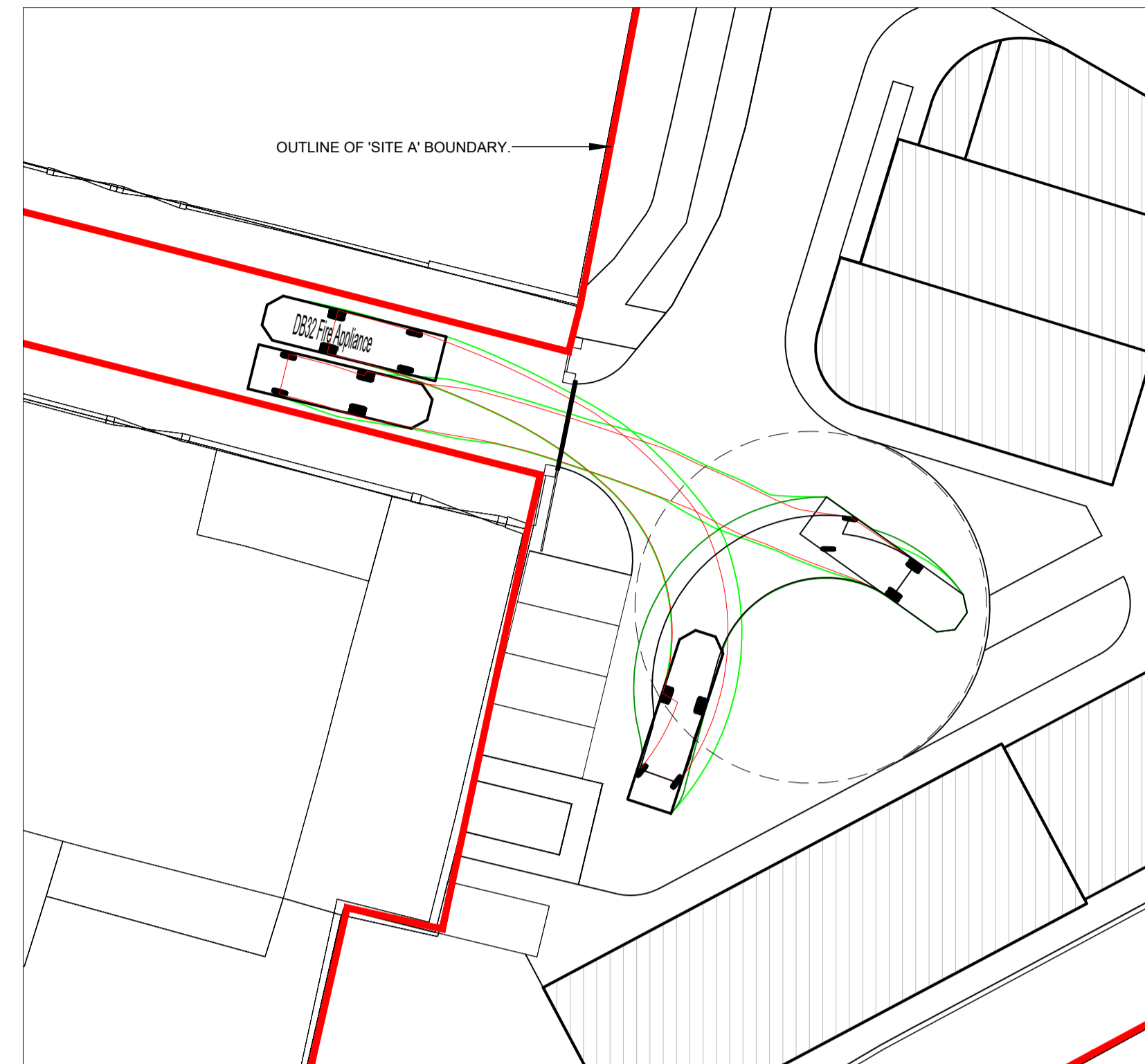
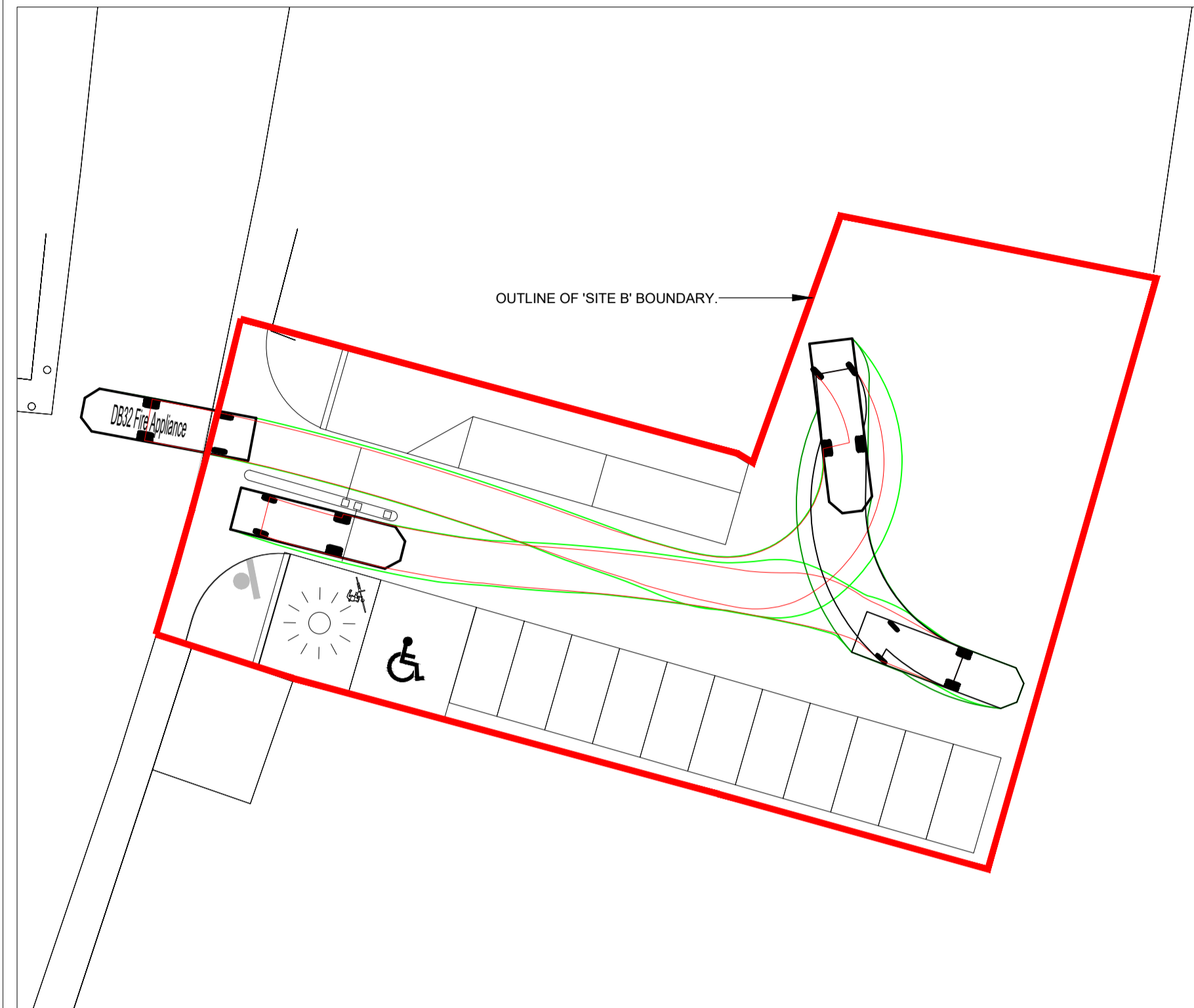

PROPOSED VEHICLE SWEEP PATH - FIRE APPLIANCE
SCALE: 1:250 @A1

NOTES:

1. ALL DIMENSIONS ARE IN MILLIMETRES AND LEVELS IN METRES UNLESS NOTED OTHERWISE.
2. USE FIGURED DIMENSIONS ONLY. DO NOT SCALE.
3. DRAWINGS TO BE READ IN CONJUNCTION WITH ALL RELEVANT ENGINEERS', ARCHITECTS' AND SERVICE ENGINEERS' DRAWINGS AND SPECIFICATIONS.

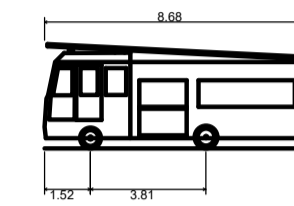

DB32 Fire Appliance	8.60m
Overall Length	2.180m
Overall Width	3.452m
Overall Body Height	0.337m
Min Body Ground Clearance	2.121m
Max Track Width	6.00s
Lock-to-lock time	7.910m
Curb to Curb Turning Radius	

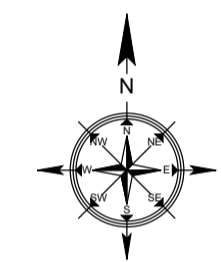

ORDNANCE SURVEY IRELAND LICENCE No. EN 0057221
© ORDNANCE SURVEY IRELAND / GOVERNMENT OF IRELAND

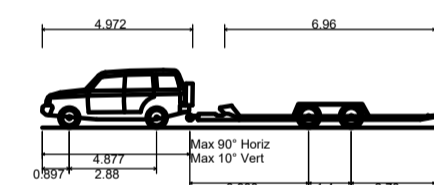

Luxury 4x4 + Trailer	12.990m
Overall Length	2.288m
Overall Width	2.524m
Overall Body Height	0.251m
Min Body Ground Clearance	2.130m
Max Track Width	4.00s
Lock-to-lock time	5.800m
Curb to Curb Turning Radius	

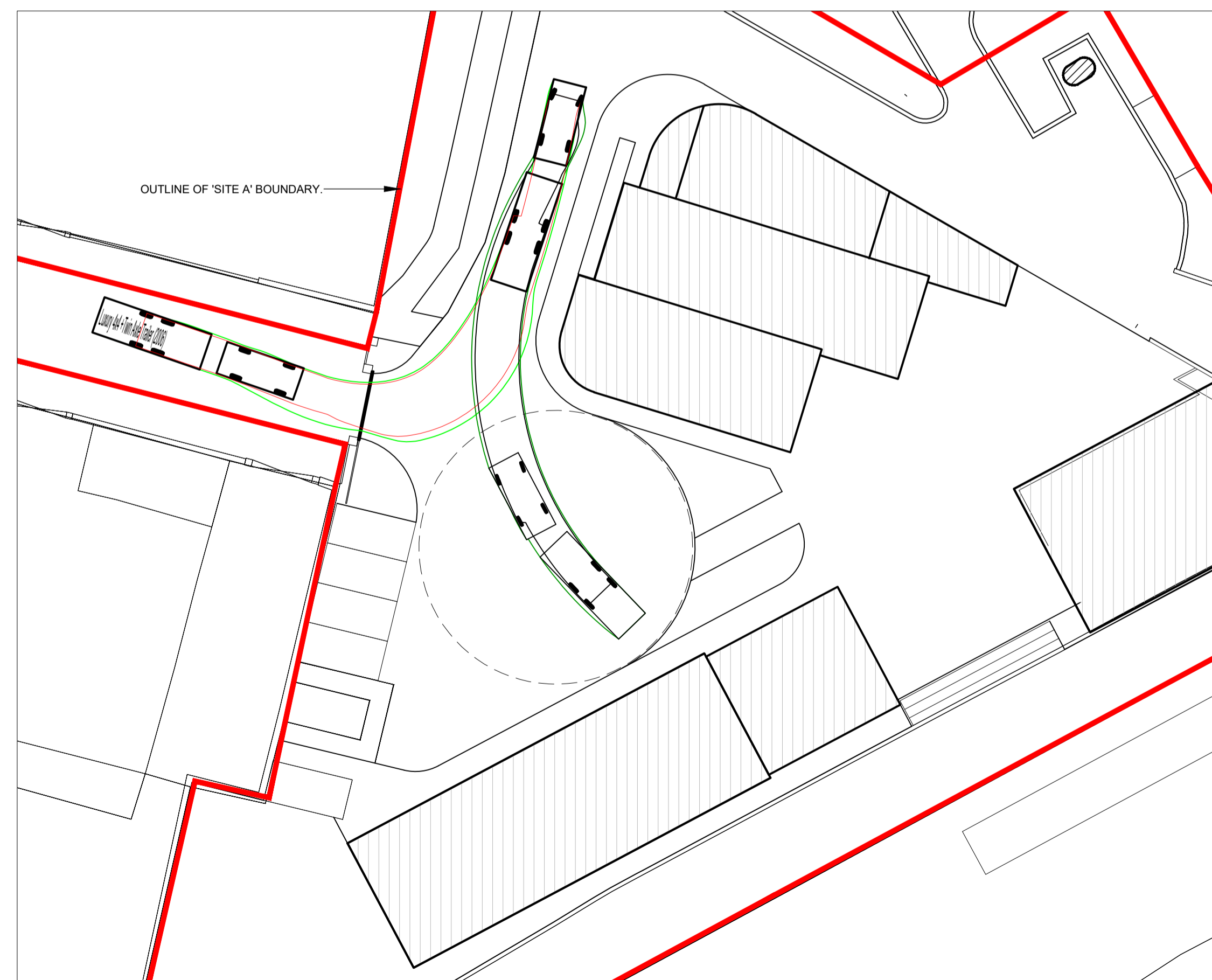
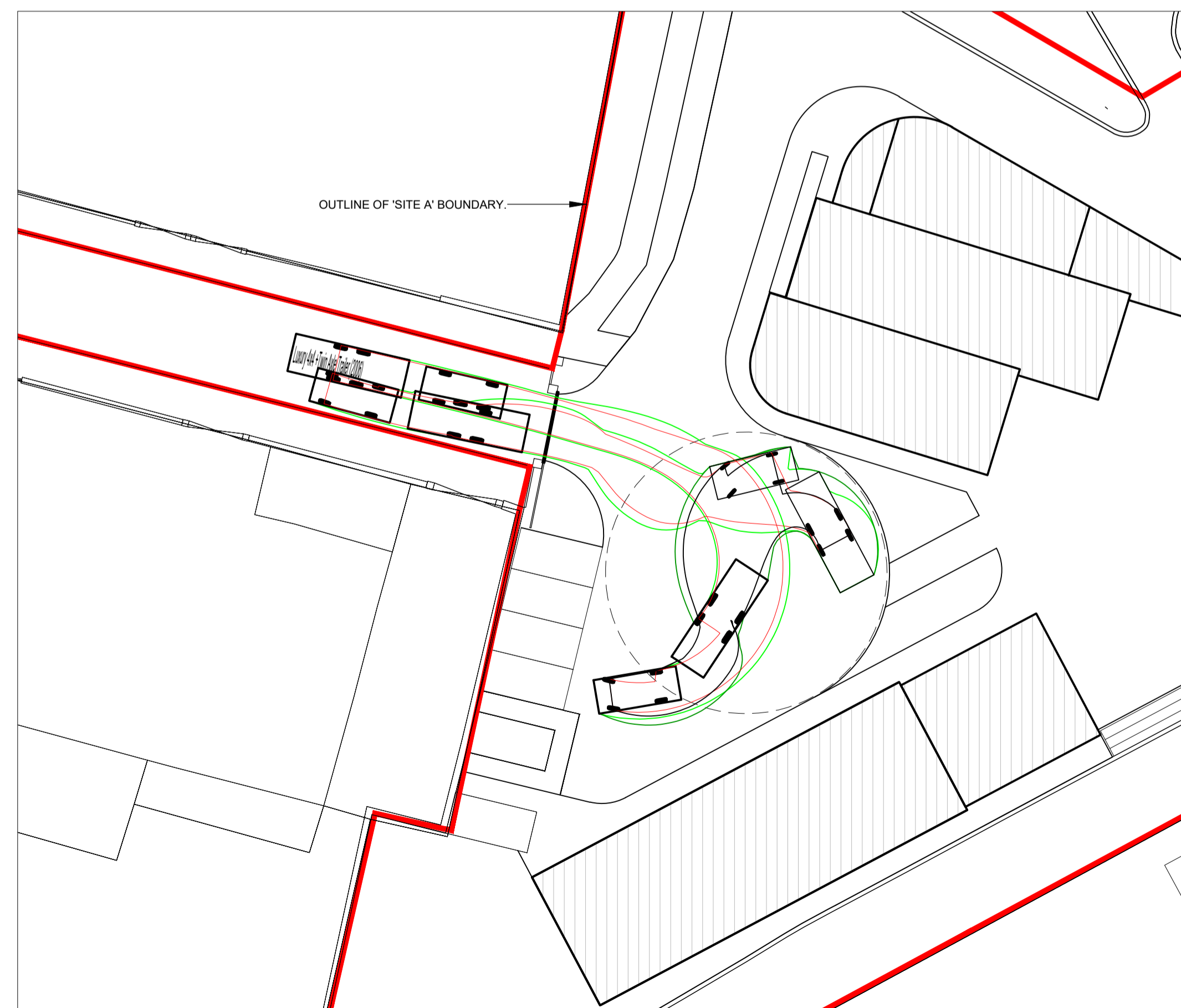

PROPOSED VEHICLE SWEEP PATH - CAR + TRAILER
SCALE: 1:250 @A1

2.	PLANNING ISSUE	R.K.	K.D.	B.H.	23.09.2021
REV.	DESCRIPTION	PROD.	VERIF.	APPR.	DATE

PLANNING



DUBLIN | LIMERICK | WEXFORD | E: info@draconsulting.ie
T: 01-216-2956 | 061-310-701 | 053-915-2814 | W: www.draconsulting.ie

CLIENT: CARLOW COUNTY COUNCIL
PROJECT: RIVER BARROW ACTIVITY CENTRE, THE PARK, CARLOW, Co. CARLOW

TITLE: PROPOSED VEHICLE SWEEP PATH				
DATE:	29/04/2021	SCALE:	1:250 @ A1	
DESIGNER:	RK	DRG. No.		REV.
PRODUCER:	RK			
VERIFIER:	KD			
APPROVER:	BH			
			K194-175	2