

NOTES

1. This drawing is the property of Carlow County Council. It is a confidential document and must not be copied, used, or its content divulged without prior written consent.
2. DO NOT SCALE. Use figured dimensions only, if in doubt ask.

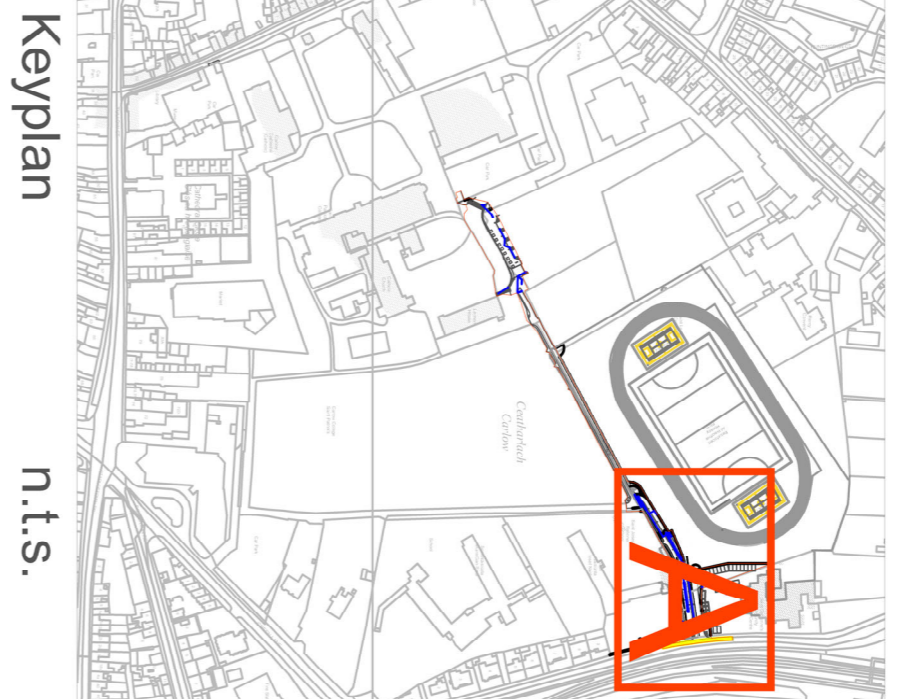

Keyplan
n.t.s.

No.	Date	Amendment / Issue	App
A	2011/21	Updated for presentation to land owners	CM
B	21/11/23	Notation updates on land parcels	CM
C	11/12/23	The block & notation updated	CM
D	15/01/24	Updated design proposal	CM
E	24/01/24	Updated pedestrian access to St. Leo's	CM
F	25/01/24	Updated design following Stakeholder meeting	CM

CARLOW COUNTY COUNCIL
 RUDF & Special Projects
 Castlehill Centre, Castle Hill, Carlow
 Phone: (051)9170300 Fax: (051)9138206
 Email: urdf@carlowcoco.ie

Carlow Local Authorities, A CPD Accredited Company

Project: Carlow URDF
 Rail Link Project

Title: GA Site Layout
 St. Joseph's Road Access

Drawn by:	CM	Job No:	2022028
Checked by:	J.C. O'Brien	Project/CAD/ID/002	DESIGN
Approved by:	-	Drg. No:	202
Date:	06-11-2023	Rev:	F

- Existing gate to be retained but no longer used for vehicular access. Be retained and repaired once existing wall is removed.
- Proposed new natural stone faced and capped wall.
- Proposed new raised table crossing point.
- Remove existing gate and boundary wall.
- Remove lamppost and relocate services underground.
- Remove existing road markings.
- Natural stone paving.
- Remove existing road markings.
- Natural stone kerbing.
- Remove existing gate and boundary wall.
- Proposed new directional information point.
- Remove existing pedestrian gate and boundary wall.
- New pedestrian gate to replace the one removed.
- Proposed new 1,200mm high stone faced wall.
- Proposed new 500mm high stone faced wall.
- Proposed new feature signage / art piece.
- Proposed new raised planter bed.
- Proposed new ACO drain to connect to new soakway.
- Existing trees to be removed in accordance with the arborists recommendations.

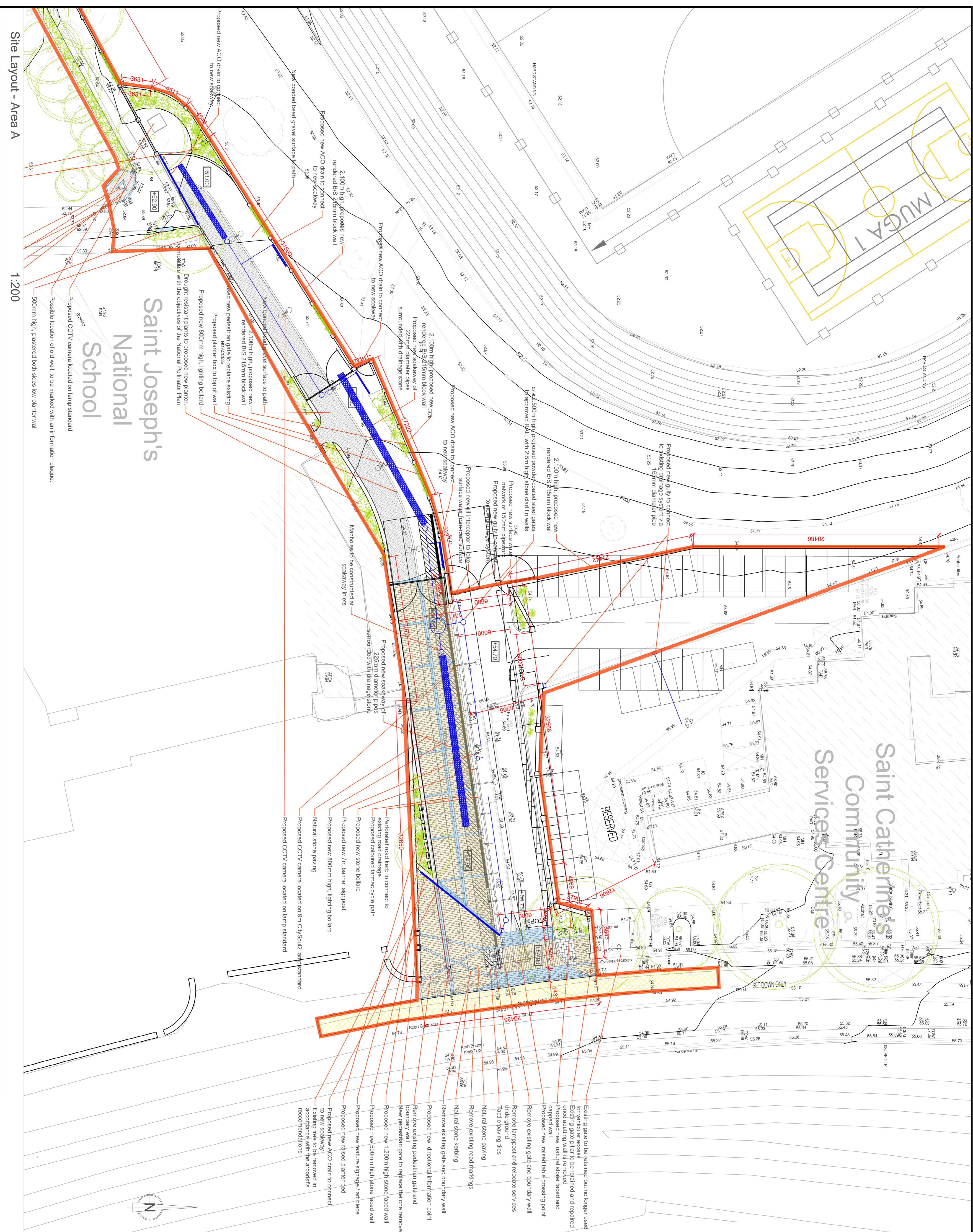

Site Layout - Area A
1:200