

SITE LOCATION
SCALE= 1:5000

LEGEND

BOUNDARY LINE

KEY PLAN

SCALE= 1:1250

COORDINATES:
X: 681971
Y: 677036

ORDNANCE SURVEY OF IRELAND LICENCE NO. EN0000825 © GOVERNMENT OF IRELAND

THIS DRAWING TO BE READ IN CONJUNCTION WITH ALL OTHER RELEVANT DESIGN TEAM DRAWINGS AND SPECIFICATIONS.
FOR SETTING OUT REFER TO ARCHITECT'S DRAWINGS. DO NOT SCALE THIS DRAWING. USE FIGURED DIMENSIONS ONLY.
NO PART OF THIS DOCUMENT MAY BE REPRODUCED OR TRANSMITTED IN ANY FORM OR STORED IN ANY RETRIEVAL SYSTEM OF ANY NATURE WITHOUT THE WRITTEN PERMISSION OF O'CONNOR SUTTON CRONIN AS COPYRIGHT HOLDER EXCEPT AS AGREED FOR USE ON THE PROJECT FOR WHICH THE DOCUMENT WAS ORIGINALLY ISSUED.

Rev No.	Date	Revision Note	Drn by	Chkd by
P01	16.03.26	ISSUED FOR INFORMATION	TM	JC
P02	20.03.26	ISSUED FOR INFORMATION	TM	JC
P03	29.04.26	ISSUED FOR INFORMATION	TM	JC

Rev No.	Date	Revision Note	Drn by	Chkd by



OCSC
O'CONNOR · SUTTON · CRONIN
MULTIDISCIPLINARY CONSULTING ENGINEERS
Civil / Structural / Environmental / Mechanical / Electrical / Sustainability
Dublin Office: 9 Prussia Street, Dublin 7. D07 KT57.
Tel: +353 (0)1 8682000 Web: www.ocsc.ie
Dublin · London · Belfast · Galway · Cork · Birmingham

Client: Carlow County Council
Project: St. Brigid's National School
Carlow Safe Routes to School
Title: Preliminary Design
Key Plan

Code	Originator	Zone	Level	Type	Role	Number	Status	Revision
C1171	OCSC	Z2	XX	DR	C	0101	S3	P03

Date: 16.03.2026 Scale: SHOWN @ A1 Drn by: TM Chkd by: JC Aprvd by: CW

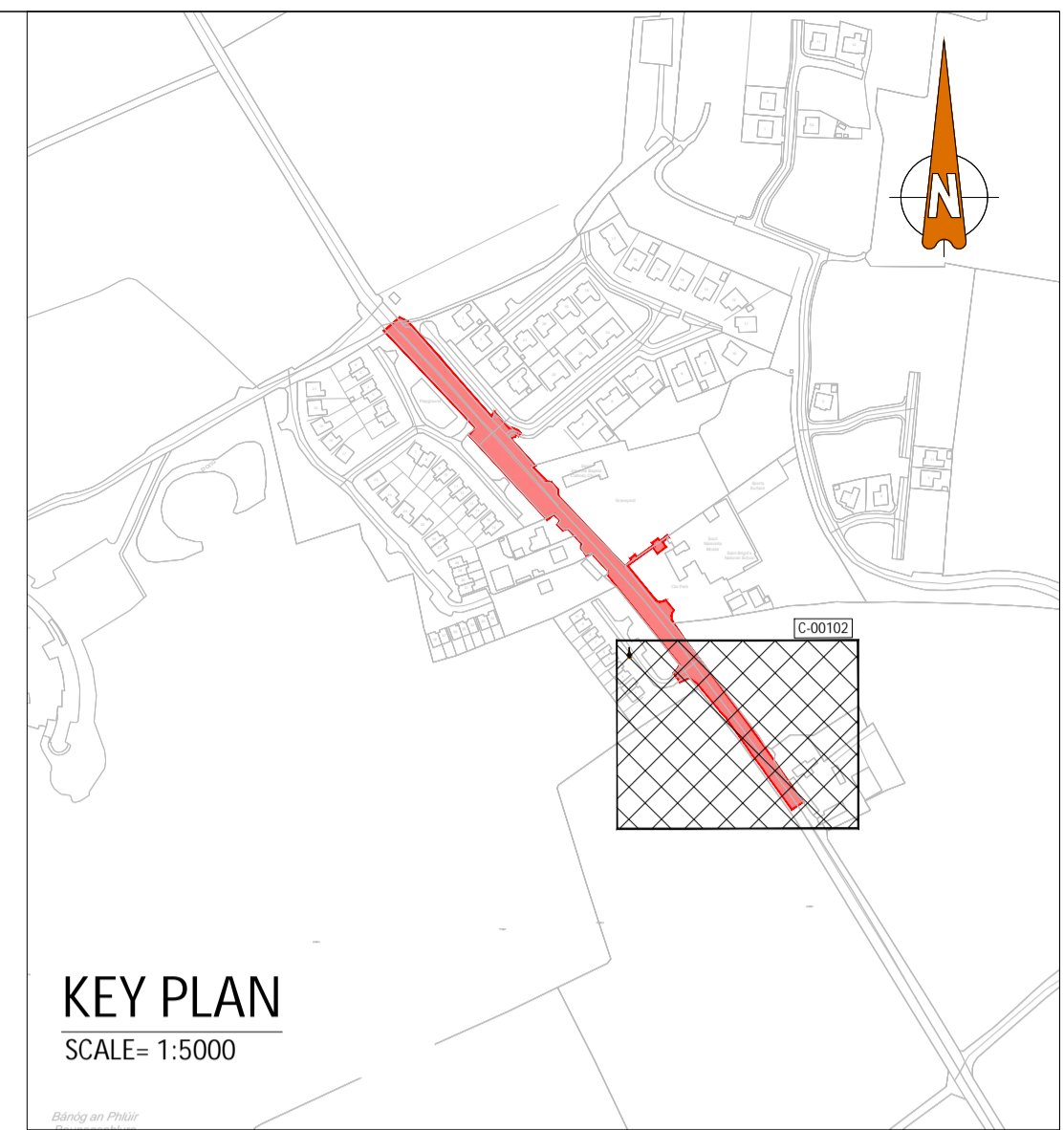
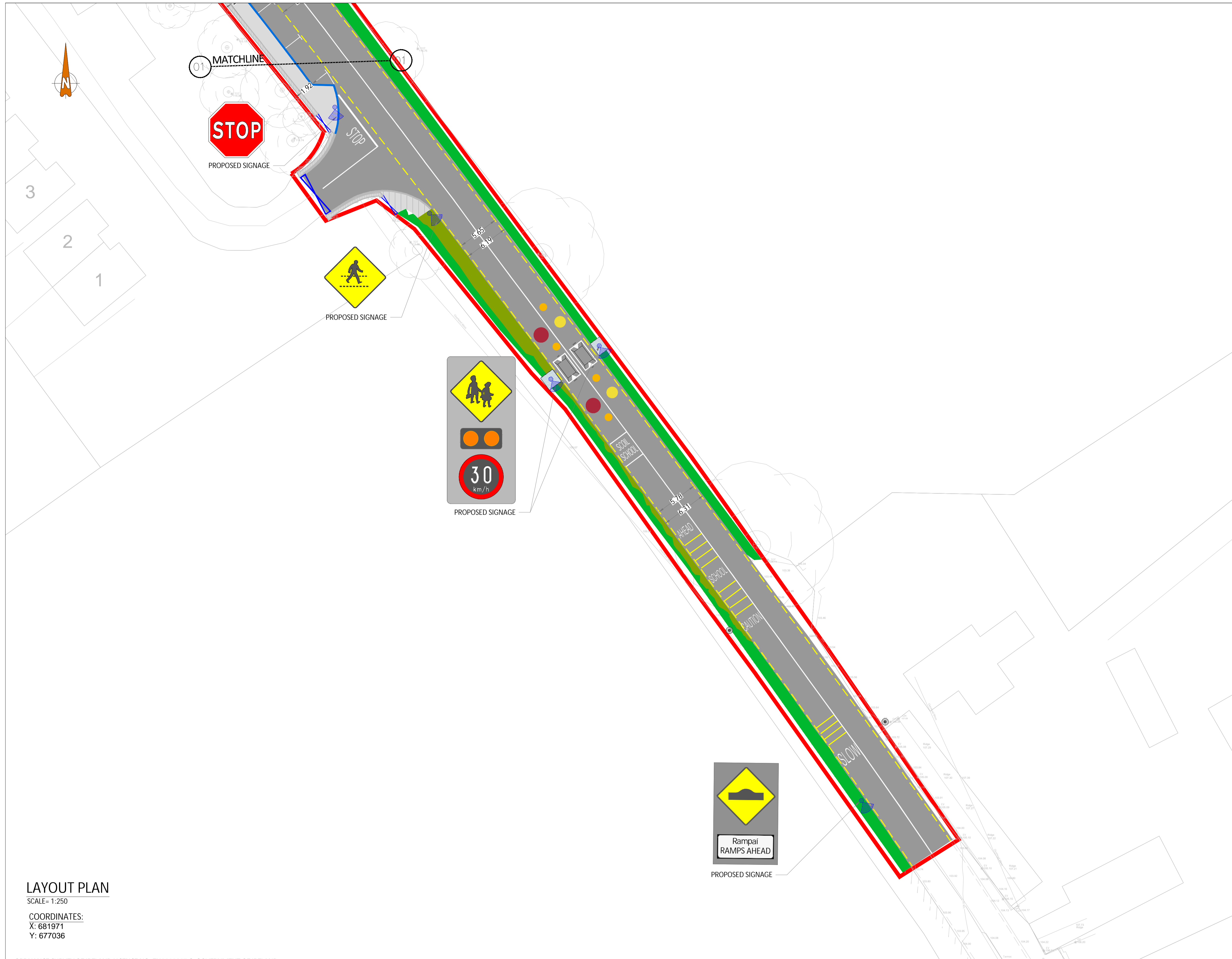

LEGEND

BOUNDARY LINE	
ROAD SURFACE	
EXISTING GRAVEL SURFACE	
EXISTING FOOTPATH	
EXISTING WALL	
EXISTING GATE	
EXISTING GATE TO BE REMOVED	
EXISTING GRASSED AREA	
EXISTING MASSIVE VEGETATION	
EXISTING KERB	
EXISTING ELECTRICITY COLUMN	
EXISTING LIGHTNING COLUMN	
EXISTING LIGHTNING COLUMN TO BE REMOVED	
PROPOSED FOOTPATH	
PROPOSED KERB	
PROPOSED GATE	
PROPOSED 'CIRCLES' ROAD MARKING (THERMOPLASTIC)	
PROPOSED GRASS	
BUFF BLISTER TACTILE PAVING (UNCONTROLLED CROSSING)	
RED BLISTER TACTILE PAVING (CONTROLLED CROSSING)	
PROPOSED BELISHA BEACON	
PROPOSED PENCIL BOLLARD	
PROPOSED LIGHTNING COLUMN	
PROPOSED WALL	
PROPOSED SIGN	
PROPOSED CONCRETE PLINT	

LAYOUT PLAN

SCALE= 1:250
 COORDINATES:
 X: 681971
 Y: 677036

ORDNANCE SURVEY OF IRELAND LICENCE NO. EN0000825 © GOVERNMENT OF IRELAND

THIS DRAWING TO BE READ IN CONJUNCTION WITH ALL OTHER RELEVANT DESIGN TEAM DRAWINGS AND SPECIFICATIONS.
 FOR SETTING OUT REFER TO ARCHITECT'S DRAWINGS. DO NOT SCALE THIS DRAWING. USE FIGURED DIMENSIONS ONLY.
 NO PART OF THIS DOCUMENT MAY BE REPRODUCED OR TRANSMITTED IN ANY FORM OR STORED IN ANY RETRIEVAL SYSTEM OF ANY NATURE WITHOUT THE WRITTEN PERMISSION OF O'CONNOR SUTTON CRONIN AS COPYRIGHT HOLDER EXCEPT AS AGREED FOR USE ON THE PROJECT FOR WHICH THE DOCUMENT WAS ORIGINALLY ISSUED.

Rev No.	Date	Revision Note	Drn by	Chkd by
P01	16.03.26	ISSUED FOR INFORMATION	TM	JC
P02	20.03.26	ISSUED FOR INFORMATION	TM	JC
P03	29.04.26	ISSUED FOR INFORMATION	TM	JC

Rev No.	Date	Revision Note	Drn by	Chkd by



OCSC
 O'CONNOR SUTTON CRONIN
 MULTIDISCIPLINARY CONSULTING ENGINEERS
 Civil / Structural / Environmental / Mechanical / Electrical / Sustainability
 Dublin Office: 9 Prussia Street, Dublin 7. D07 KT57.
 Tel: +353 (0)1 8682000 Web: www.ocsc.ie
 Dublin · London · Belfast · Galway · Cork · Birmingham

Client:	Carlow County Council							
Project:	St. Brigid's National School Carlow Safe Routes to School							
Title:	Preliminary Design Layout Plan Sheet 01 of 05							
Code	Originator	Zone	Level	Type	Role	Number	Status	Revision
C1171	OCSC	Z2	XX	DR	C	0102	S3	P03
Date: 16.03.2026	Scale: SHOWN @ A1	Drn by: TM	Chkd by: JC	Aprvd by: CW				

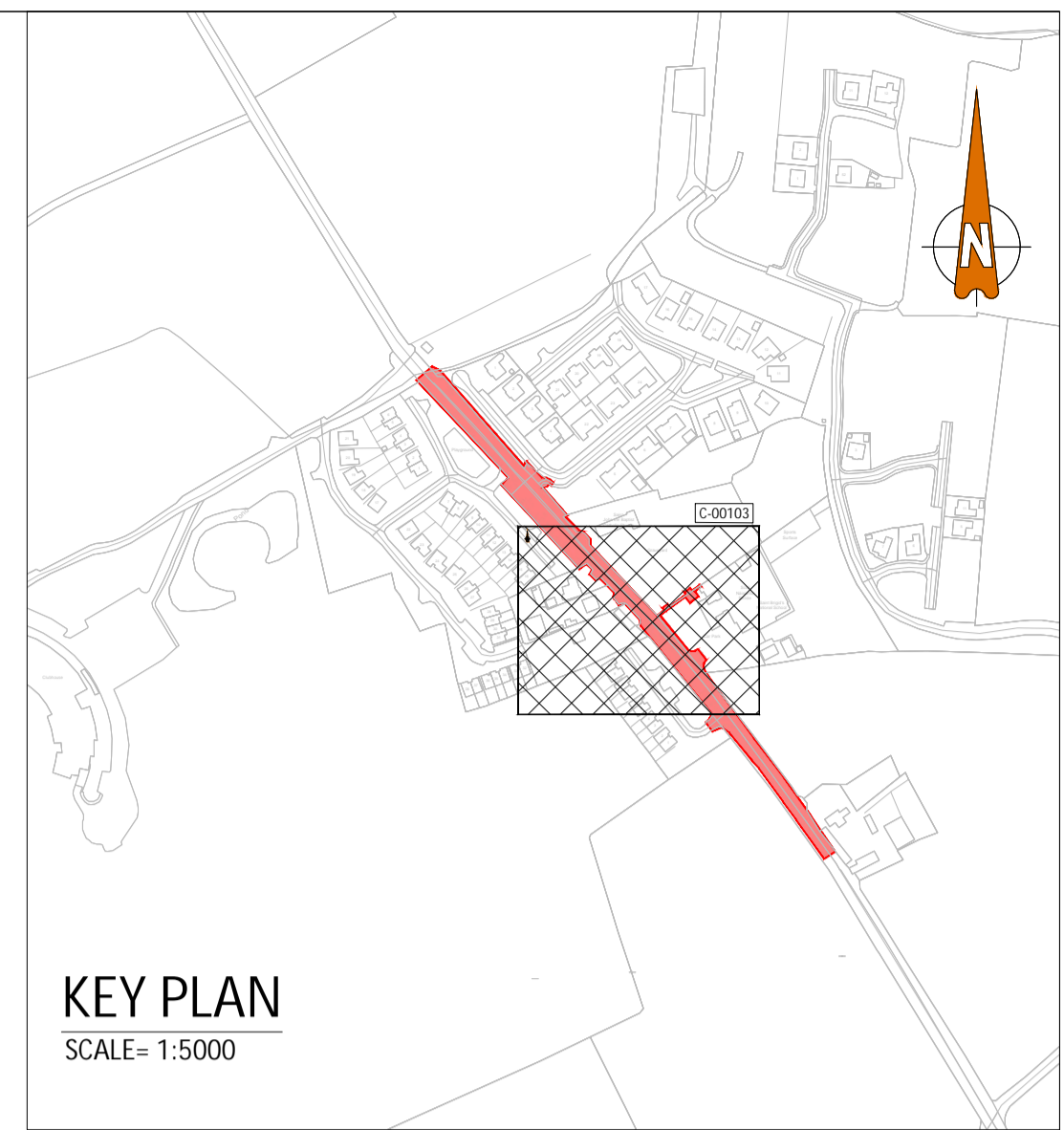
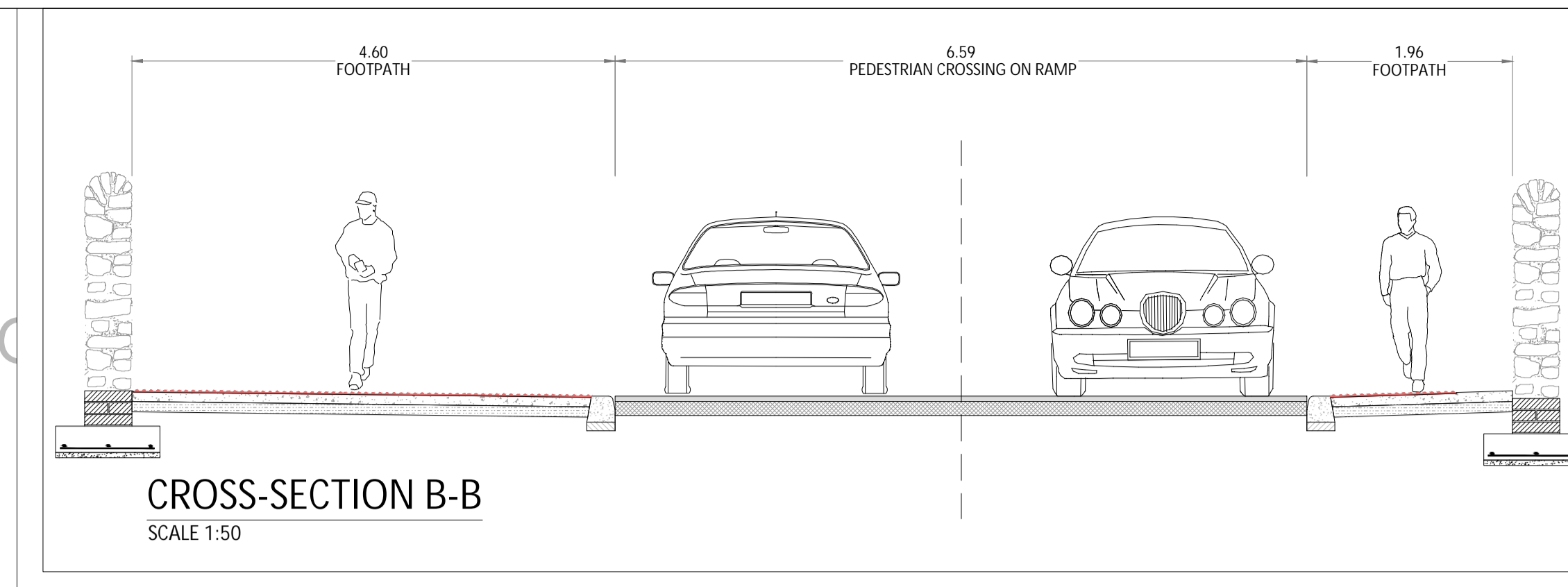
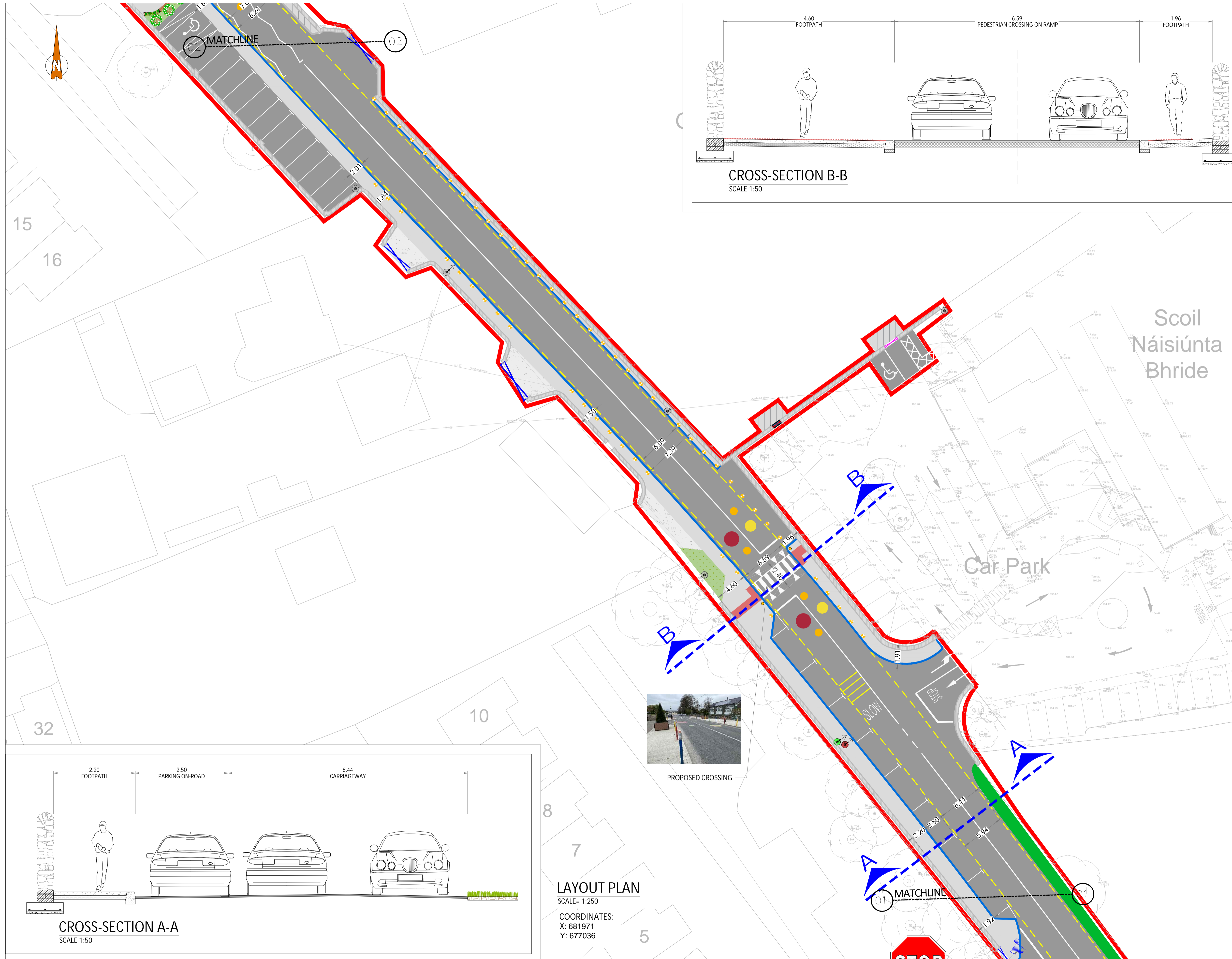

LEGEND

BOUNDARY LINE	[Red line symbol]
ROAD SURFACE	[Grey hatched symbol]
EXISTING GRAVEL SURFACE	[Grey hatched symbol]
EXISTING FOOTPATH	[Grey hatched symbol]
EXISTING WALL	[Grey line symbol]
EXISTING GATE	[Blue line symbol]
EXISTING GATE TO BE REMOVED	[Red line symbol]
EXISTING GRASSED AREA	[Green hatched symbol]
EXISTING MASSIVE VEGETATION	[Dark green hatched symbol]
EXISTING KERB	[Blue line symbol]
EXISTING ELECTRICITY COLUMN	[Circle with cross symbol]
EXISTING LIGHTNING COLUMN	[Circle with dot symbol]
EXISTING LIGHTNING COLUMN TO BE REMOVED	[Circle with dot and slash symbol]
PROPOSED FOOTPATH	[Blue line symbol]
PROPOSED KERB	[Blue line symbol]
PROPOSED GATE	[Blue line symbol]
PROPOSED 'CIRCLES' ROAD MARKING (THERMOPLASTIC)	[Red, yellow, and blue circles symbol]
PROPOSED GRASS	[Green hatched symbol]
BUFF BLISTER TACTILE PAVING (UNCONTROLLED CROSSING)	[Yellow hatched symbol]
RED BLISTER TACTILE PAVING (CONTROLLED CROSSING)	[Red hatched symbol]
PROPOSED BELISHA BEACON	[Yellow circle symbol]
PROPOSED PENCIL BOLLARD	[Yellow dot symbol]
PROPOSED LIGHTNING COLUMN	[Green circle with dot symbol]
PROPOSED WALL	[Blue line symbol]
PROPOSED SIGN	[Blue line symbol]
PROPOSED CONCRETE PLINT	[Blue line symbol]

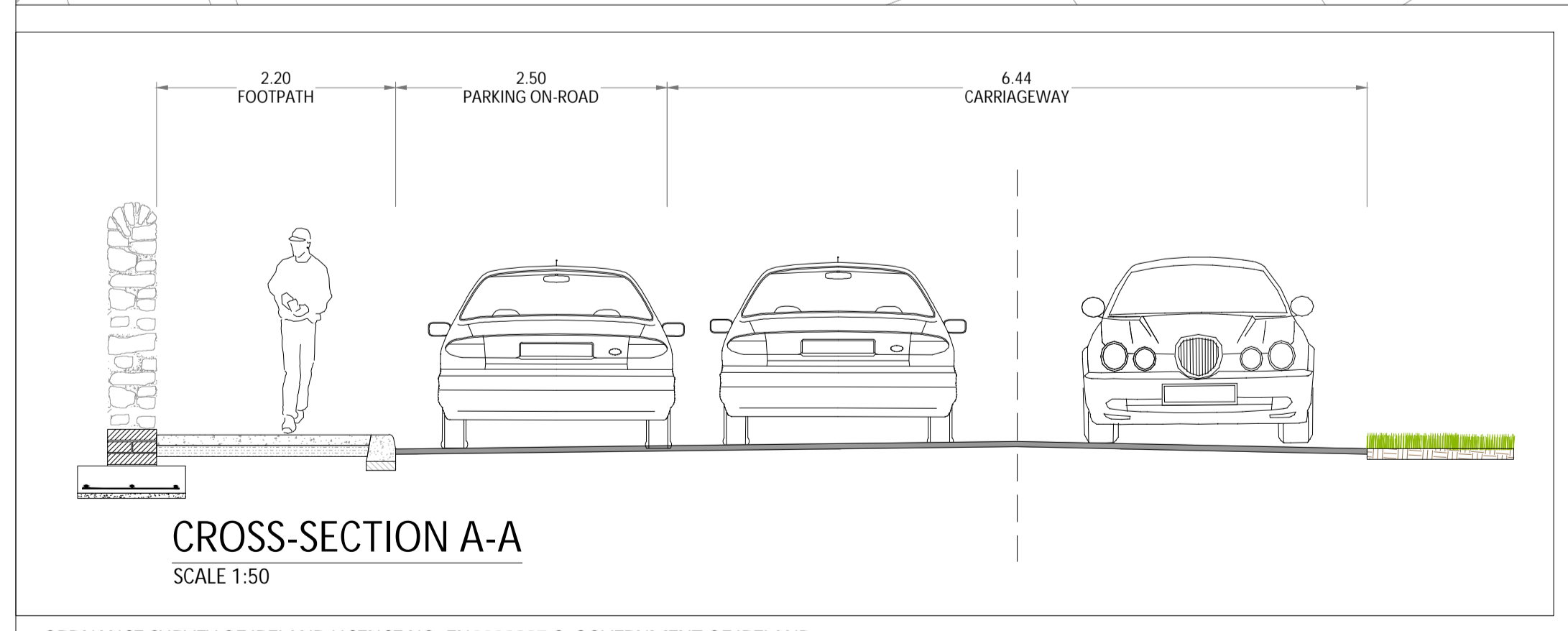

LAYOUT PLAN
SCALE= 1:250
COORDINATES:
X: 681971
Y: 677036

ORDNANCE SURVEY OF IRELAND LICENCE NO. EN0000825 © GOVERNMENT OF IRELAND

THIS DRAWING TO BE READ IN CONJUNCTION WITH ALL OTHER RELEVANT DESIGN TEAM DRAWINGS AND SPECIFICATIONS.
FOR SETTING OUT REFER TO ARCHITECT'S DRAWINGS. DO NOT SCALE THIS DRAWING. USE FIGURED DIMENSIONS ONLY.
NO PART OF THIS DOCUMENT MAY BE REPRODUCED OR TRANSMITTED IN ANY FORM OR STORED IN ANY RETRIEVAL SYSTEM OF ANY NATURE WITHOUT THE WRITTEN PERMISSION OF O'CONNOR SUTTON CRONIN AS COPYRIGHT HOLDER EXCEPT AS AGREED FOR USE ON THE PROJECT FOR WHICH THE DOCUMENT WAS ORIGINALLY ISSUED.

Rev No.	Date	Revision Note	Drn by	Chkd by
P01	16.03.26	ISSUED FOR INFORMATION	TM	JC
P02	20.03.26	ISSUED FOR INFORMATION	TM	JC
P03	29.04.26	ISSUED FOR INFORMATION	TM	JC

Rev No.	Date	Revision Note	Drn by	Chkd by



OCSC
O'CONNOR SUTTON CRONIN
MULTIDISCIPLINARY CONSULTING ENGINEERS
Civil / Structural / Environmental / Mechanical / Electrical / Sustainability
Dublin Office: 9 Prussia Street, Dublin 7, D07 KT57.
Tel: +353 (0)1 8682000 Web: www.ocsc.ie
Dublin · London · Belfast · Galway · Cork · Birmingham

Client: Carlow County Council
Project: St. Brigid's National School
Carlow Safe Routes to School
Title: Preliminary Design
Layout Plan
Sheet 02 of 05

Code	Originator	Zone	Level	Type	Role	Number	Status	Revision
C1171	OCSC	Z2	XX	DR	C	0103	S3	P03

Date: 16.03.2026 Scale: SHOWN @ A1 Drn by: TM Chkd by: JC Aprvd by: CW

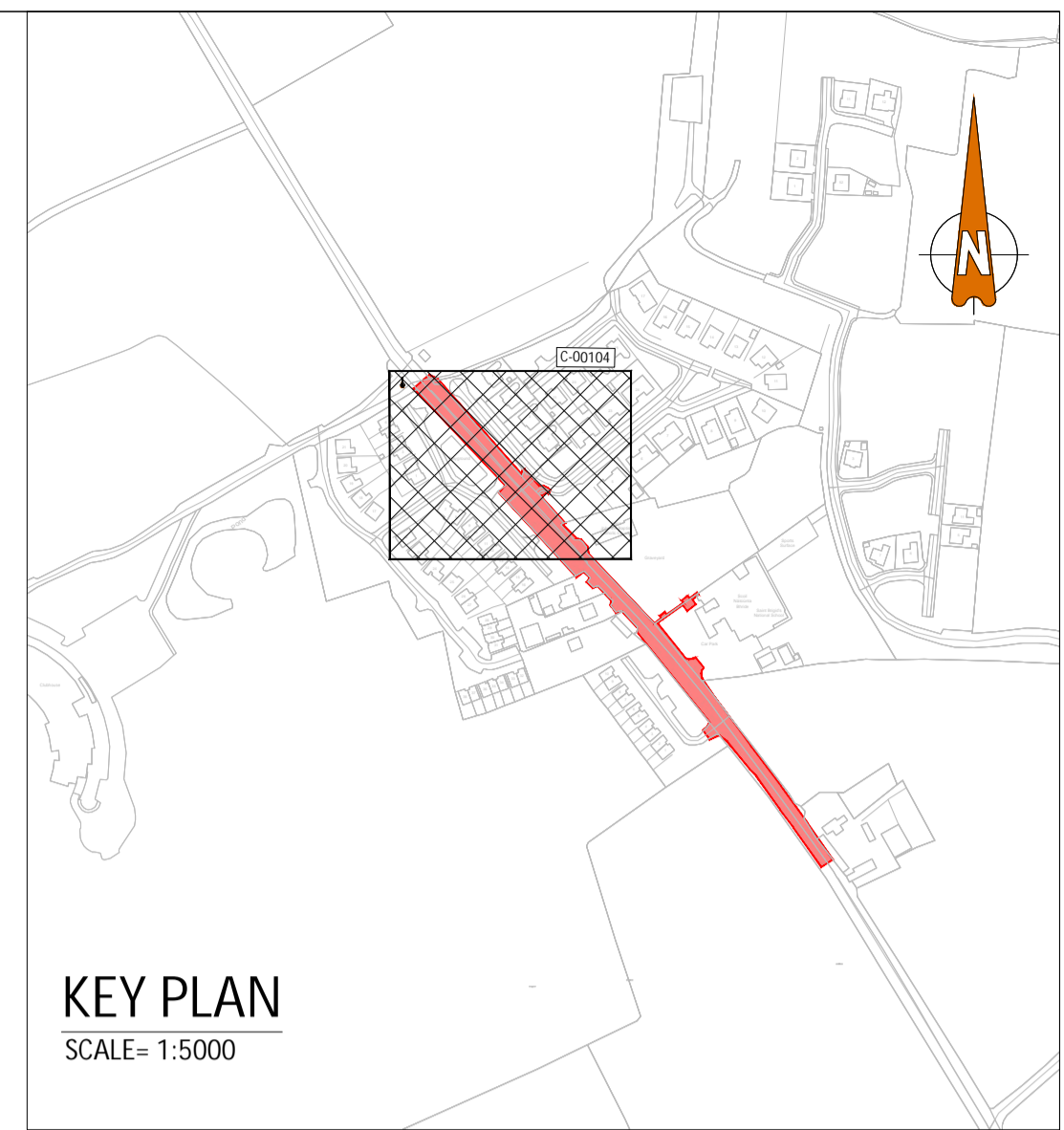
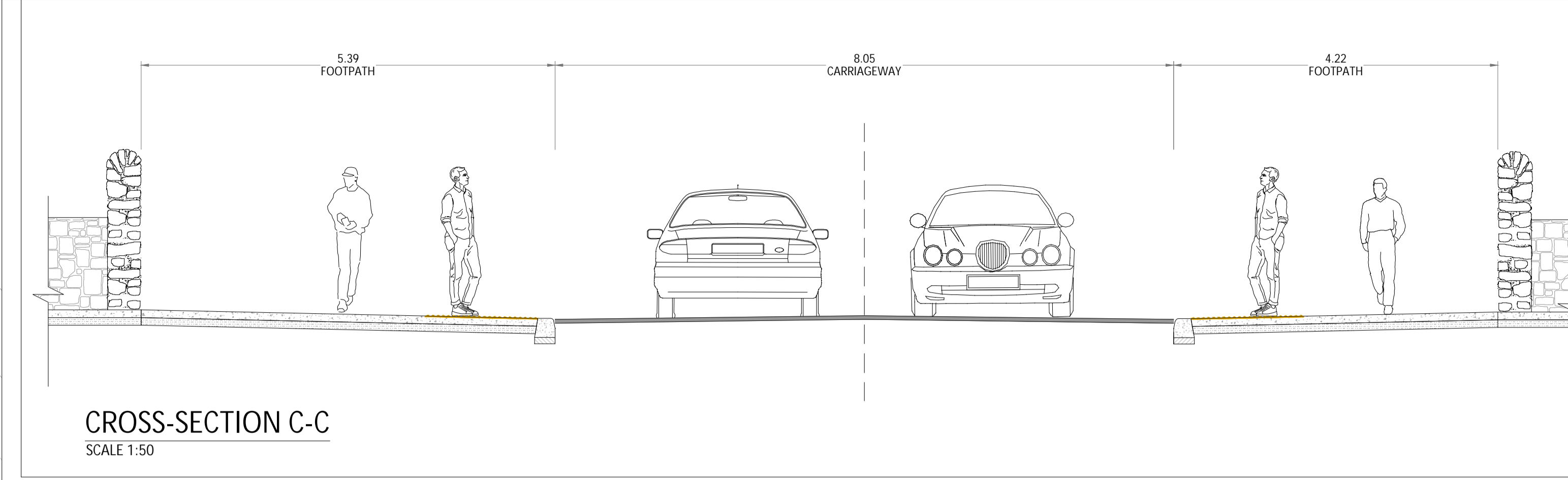
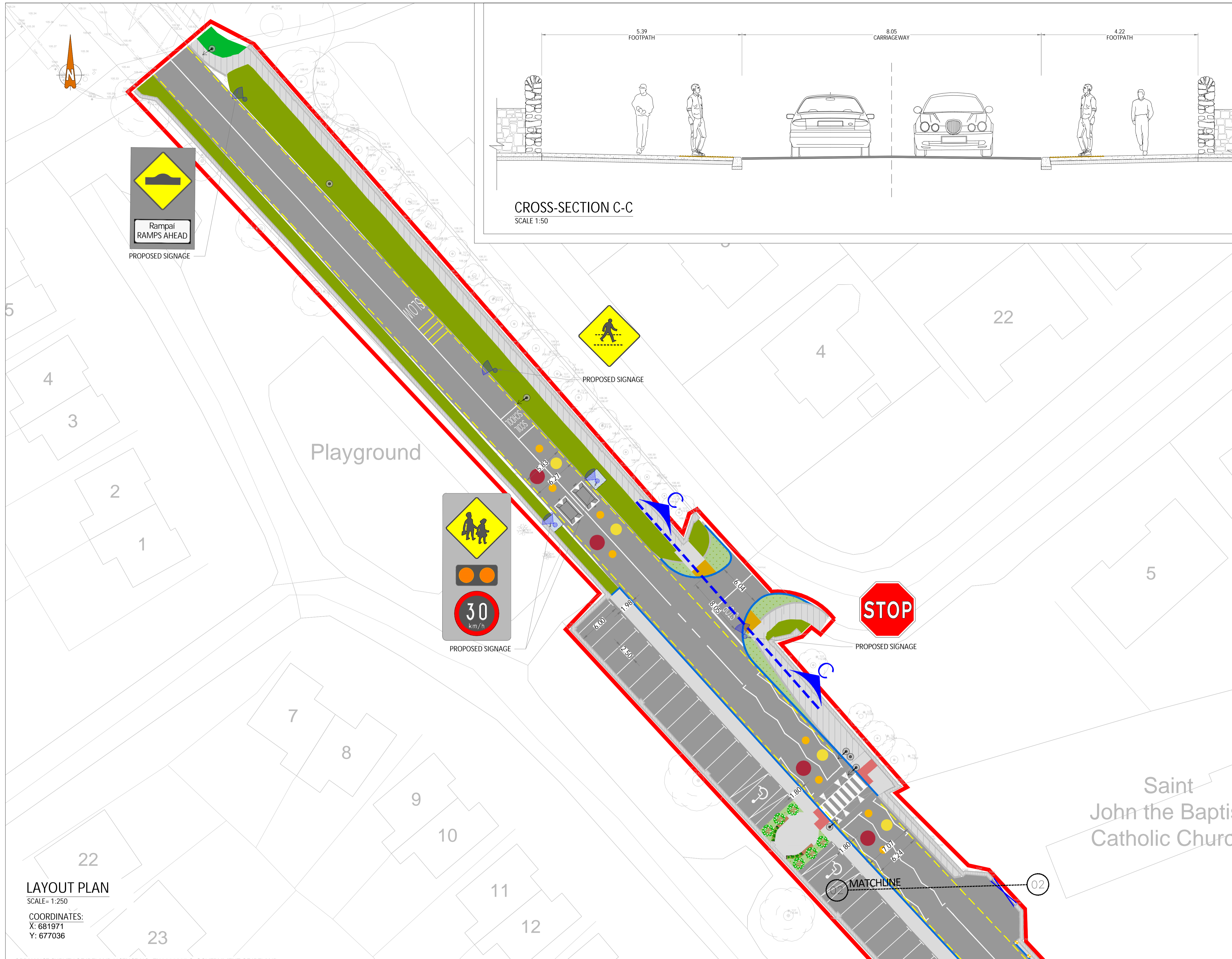

LEGEND

BOUNDARY LINE	
ROAD SURFACE	
EXISTING GRAVEL SURFACE	
EXISTING FOOTPATH	
EXISTING WALL	
EXISTING GATE	
EXISTING GATE TO BE REMOVED	
EXISTING GRASSED AREA	
EXISTING MASSIVE VEGETATION	
EXISTING KERB	
EXISTING ELECTRICITY COLUMN	
EXISTING LIGHTNING COLUMN	
EXISTING LIGHTNING COLUMN TO BE REMOVED	
PROPOSED FOOTPATH	
PROPOSED KERB	
PROPOSED GATE	
PROPOSED 'CIRCLES' ROAD MARKING (THERMOPLASTIC)	
PROPOSED GRASS	
BUFF BLISTER TACTILE PAVING (UNCONTROLLED CROSSING)	
RED BLISTER TACTILE PAVING (CONTROLLED CROSSING)	
PROPOSED BELISHA BEACON	
PROPOSED PENCIL BOLLARD	
PROPOSED LIGHTNING COLUMN	
PROPOSED WALL	
PROPOSED SIGN	
PROPOSED CONCRETE PLINT	

LAYOUT PLAN

SCALE= 1:250
 COORDINATES:
 X: 681971
 Y: 677036

ORDNANCE SURVEY OF IRELAND LICENCE NO. EN0000825 © GOVERNMENT OF IRELAND

THIS DRAWING TO BE READ IN CONJUNCTION WITH ALL OTHER RELEVANT DESIGN TEAM DRAWINGS AND SPECIFICATIONS.
 FOR SETTING OUT REFER TO ARCHITECT'S DRAWINGS. DO NOT SCALE THIS DRAWING. USE FIGURED DIMENSIONS ONLY.
 NO PART OF THIS DOCUMENT MAY BE REPRODUCED OR TRANSMITTED IN ANY FORM OR STORED IN ANY RETRIEVAL SYSTEM OF ANY NATURE WITHOUT THE WRITTEN PERMISSION OF O'CONNOR SUTTON CRONIN AS COPYRIGHT HOLDER EXCEPT AS AGREED FOR USE ON THE PROJECT FOR WHICH THE DOCUMENT WAS ORIGINALLY ISSUED.

Rev No.	Date	Revision Note	Drn by	Chkd by	Rev No.	Date	Revision Note	Drn by	Chkd by
P01	16.03.26	ISSUED FOR INFORMATION	TM	JC					
P02	20.03.26	ISSUED FOR INFORMATION	TM	JC					
P03	29.04.26	ISSUED FOR INFORMATION	TM	JC					



OCSC
 O'CONNOR · SUTTON · CRONIN
 MULTIDISCIPLINARY CONSULTING ENGINEERS
 Civil / Structural / Environmental / Mechanical / Electrical / Sustainability
 Dublin Office: 9 Prussia Street, Dublin 7, D07 KT57.
 Tel: +353 (0)1 8682000 Web: www.ocsc.ie
 Dublin · London · Belfast · Galway · Cork · Birmingham

Client: Carlow County Council
 Project: St. Brigid's National School
 Carlow Safe Routes to School
 Title: Preliminary Design
 Layout Plan
 Sheet 03 of 05

Code	Originator	Zone	Level	Type	Role	Number	Status	Revision
C1171	OCSC	Z2	XX	DR	C	0104	S3	P03

Date: 16.03.2026 Scale: SHOWN @ A1 Drn by: TM Chkd by: JC Aprvd by: CW