

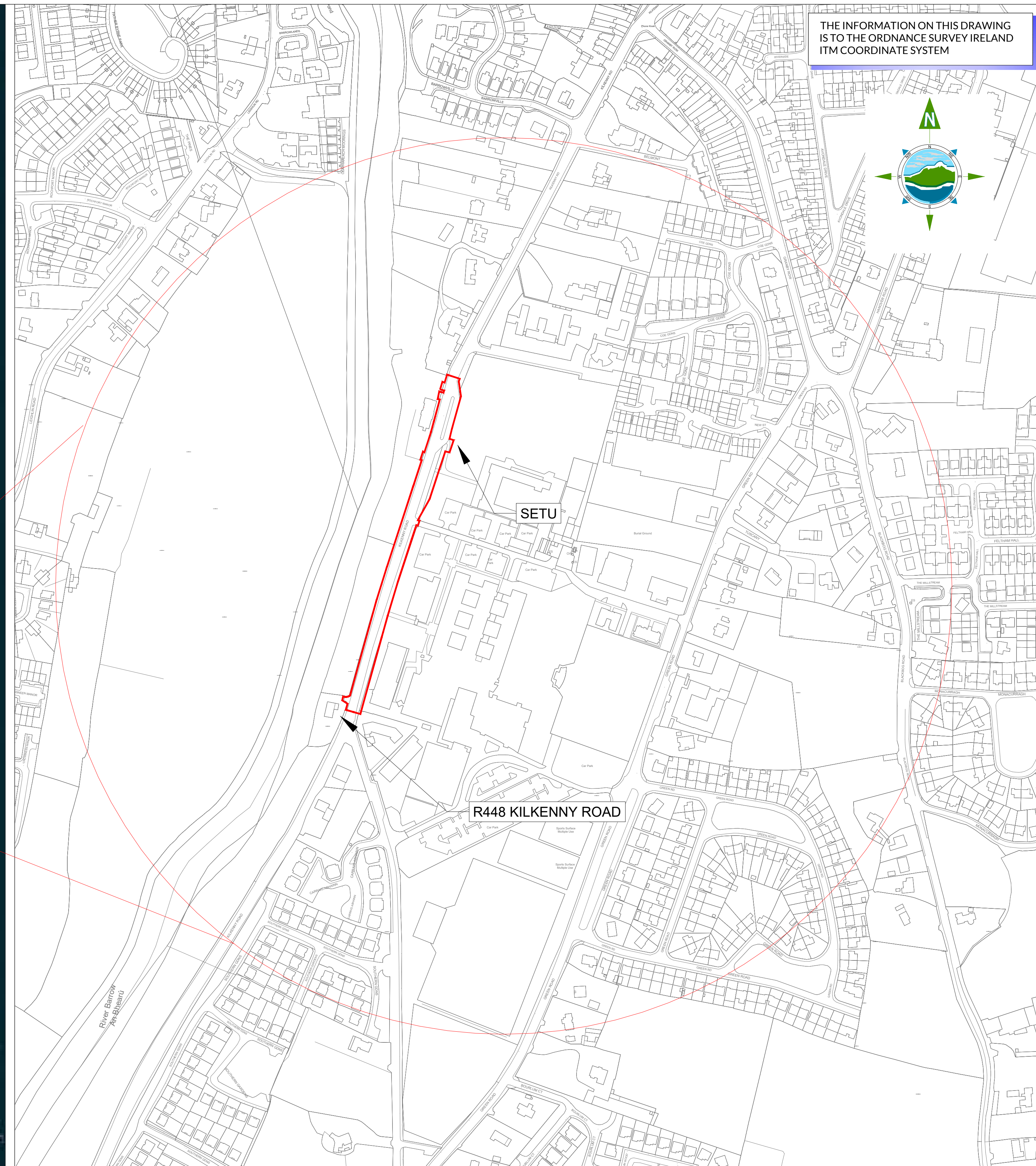

© 2022 Microsoft Corporation Earthstar Geographics SIO



**NOTES:**

1. FIGURED DIMENSIONS ONLY TO BE TAKEN FROM THIS DRAWING.
2. ALL DRAWINGS TO BE CHECKED BY THE CONTRACTOR ON SITE.
3. ENGINEER/EMPLOYERS REPRESENTATIVE, AS APPROPRIATE, TO BE INFORMED BY THE CONTRACTOR OF ANY DISCREPANCIES BEFORE ANY WORK COMMENCES.
4. THE CONTRACTOR SHALL UNDERTAKE A THOROUGH CHECK FOR THE ACTUAL LOCATION OF ALL SERVICES/UTILITIES, ABOVE AND BELOW GROUND, BEFORE ANY WORK COMMENCES.
5. ALL LEVELS SHOWN RELATE TO ORDNANCE SURVEY DATUM AT MALIN HEAD.

Rev	Date	Description	By	Chkd.
A	22-05-24	Preliminary	TI	MR

Client:	Carlow County Council
Project:	PC Hanover to Carlow IT Phase 4
Title:	Location Map

Prepared by:	TI
Checked by:	PC
Date:	29-05-2023
Drawing Status:	Preliminary
Scale @ A1:	2500

**TOBIN**  
CONSULTING ENGINEERS

Tel: +353 (0)91 565 211  
Email: info@tobin.ie  
www.tobin.ie

Drawing No.: **11469 - 2300**

Revision: **A**



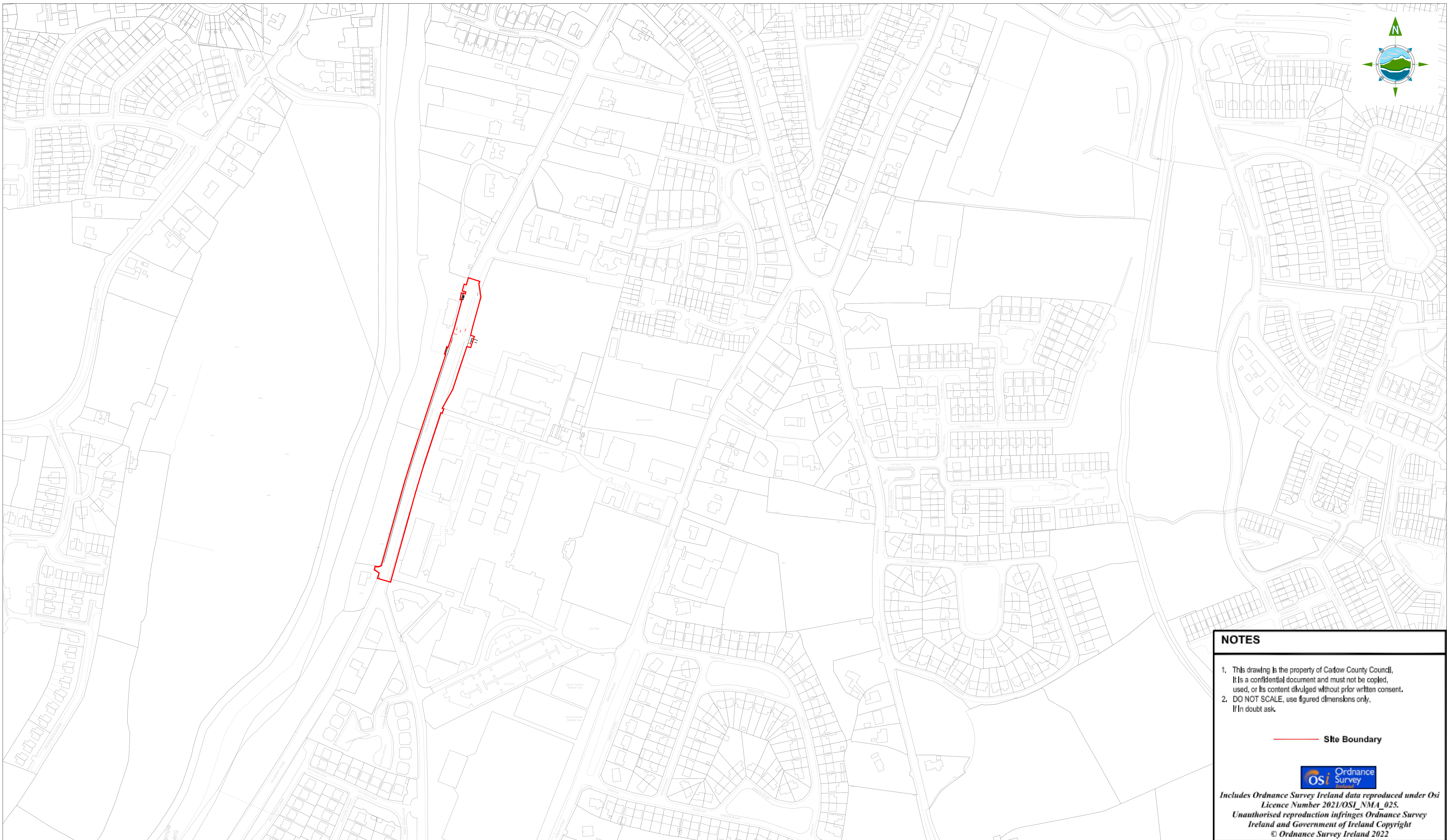
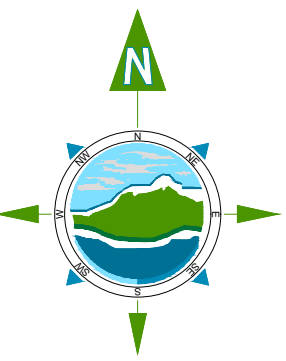

**NOTES**

- This drawing is the property of Carlow County Council. It is a confidential document and must not be copied, used, or its content divulged without prior written consent.
- DO NOT SCALE, use figured dimensions only. If in doubt ask.

— Site Boundary



Includes Ordnance Survey Ireland data reproduced under Osi Licence Number 2021/OSI\_NMA\_025. Unauthorised reproduction infringes Ordnance Survey Ireland and Government of Ireland Copyright © Ordnance Survey Ireland 2022

**LEGEND:**  
— Site Boundary

Rev	Date	Description	By	Chkd.
D01	22/05/24	Draft for Approval	MR	PC

Client:   
Carlow County Council

Project: Active Travel Pathfinder  
Carlow To SETU Pedestrian & Cycle Scheme

Title: Proposed Layout For Consultation

Prepared by: T I  
Checked: P C  
Date: 22/05/24  
Project Director: JOF  
Drawing Status: Preliminary  
Scale @ A1: 1:500

**TOBIN**

Tel: +353 (0)91 565 211  
Email: info@tobin.ie  
www.tobin.ie

TOBIN Consulting Engineers will not be liable for any use of this document for any purpose other than that for which it was originally prepared and provided. Except where specifically and explicitly agreed in writing by TOBIN Consulting Engineers, no copyright holder, no part of this document may be reproduced or transmitted in any form or by any means, electronic or mechanical, including photocopying, recording, or by any information storage and retrieval system, without prior written permission from TOBIN Consulting Engineers.

Drawing No.: 11469 - 2301

Revision: A



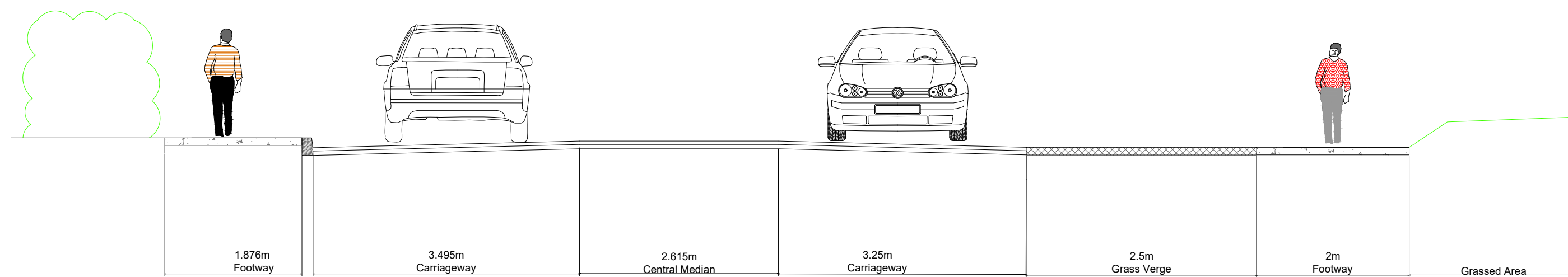
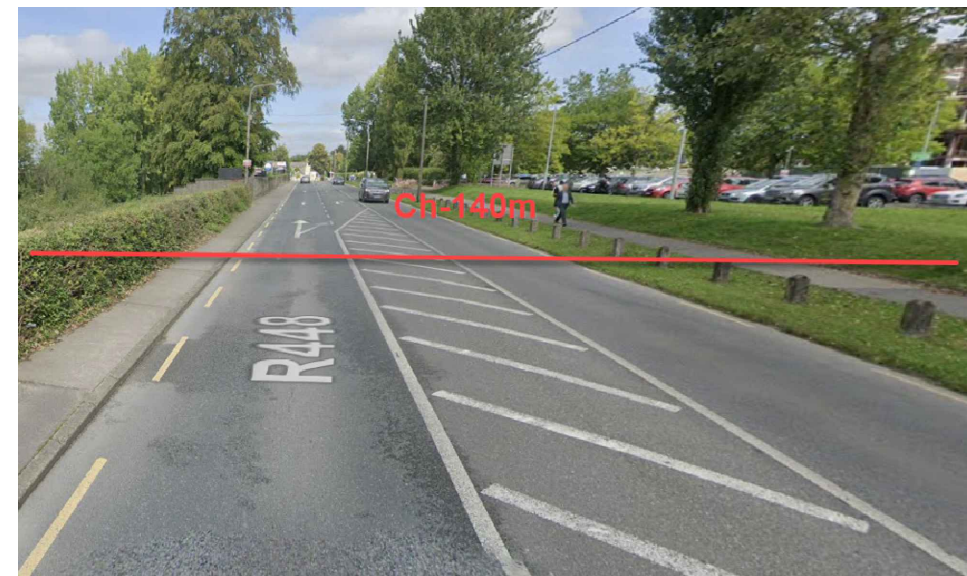
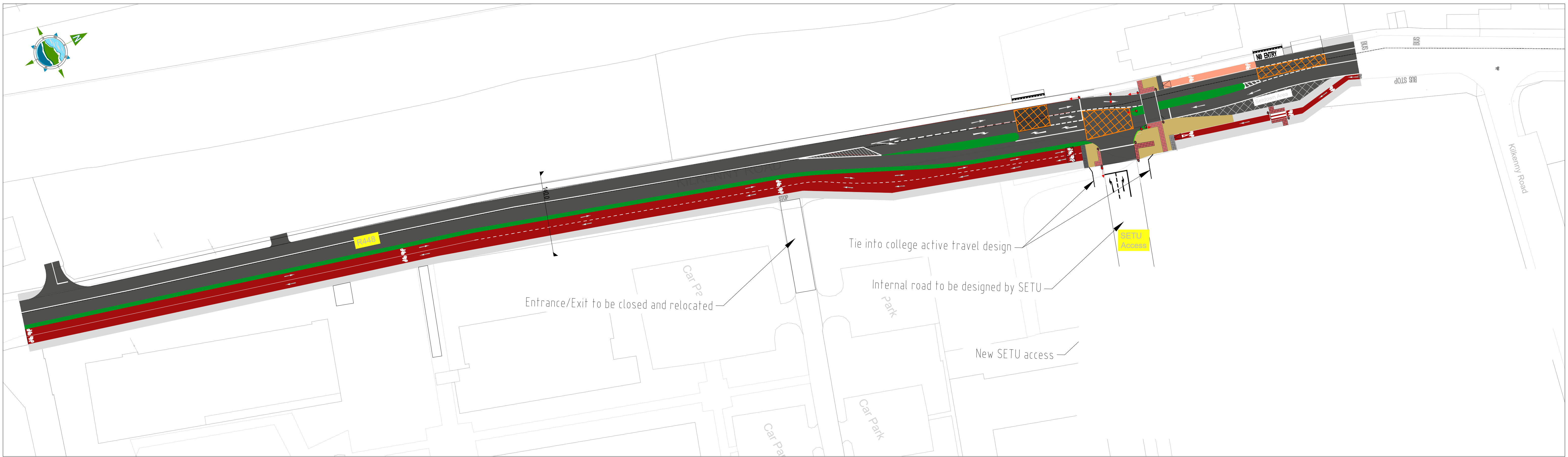

Existing Cross-section Ch. 0 - 200m

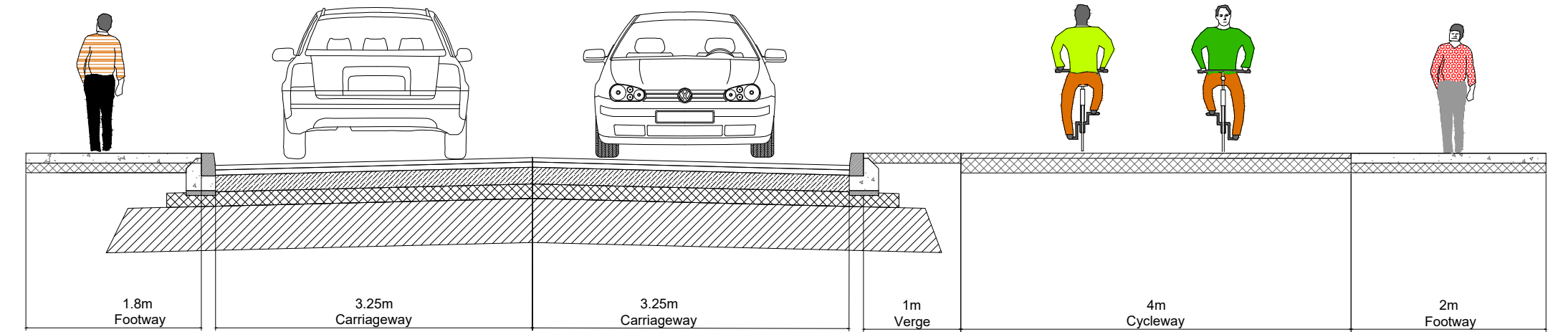

Proposed Cross-section Ch. 0 - 200m

Preliminary Design Option 1  
Scale 1:500 @ A1

- LEGEND:**
- Proposed Pavement
  - Proposed Concrete Footway
  - Proposed Cycle Track
  - Primary Signal
  - Push Button Signal at Crossing

Rev	Date	Description	By	Chkd.
A	22/12/22	Draft for Approval	TI	PC

Client: **CARLOW COUNTY COUNCIL**  
COMHAIRLE CHONTAE CHEATHARLACH  
Carlow County Council

Project: **Active Travel Pathfinder**  
**Carlow To SETU Pedestrian & Cycle Scheme**

Title: **Proposed Layout For Consultation**

Prepared by: TI  
Checked: PC  
Date: 22/05/24  
Project Director: JOF  
Drawing Status: Preliminary  
Scale @ A1: 1:500

**TOBIN**  
Tel: +353 (0)91 565 211  
Email: info@tobin.ie  
www.tobin.ie

TOBIN Consulting Engineers will not be liable for any use of this document for any purpose other than that for which it was originally prepared and provided. Except where specifically and explicitly agreed in writing by TOBIN Consulting Engineers, its copyright holder, no part of this document may be reproduced or transmitted in any form or by any means, electronic or mechanical, including photocopying and recording, or by any information storage or retrieval system, without prior written permission from TOBIN Consulting Engineers.

Drawing No.: **11469 - 2302**

Revision: **A**