

2 Proposed First Floor Plan showing Demolition  
1:100

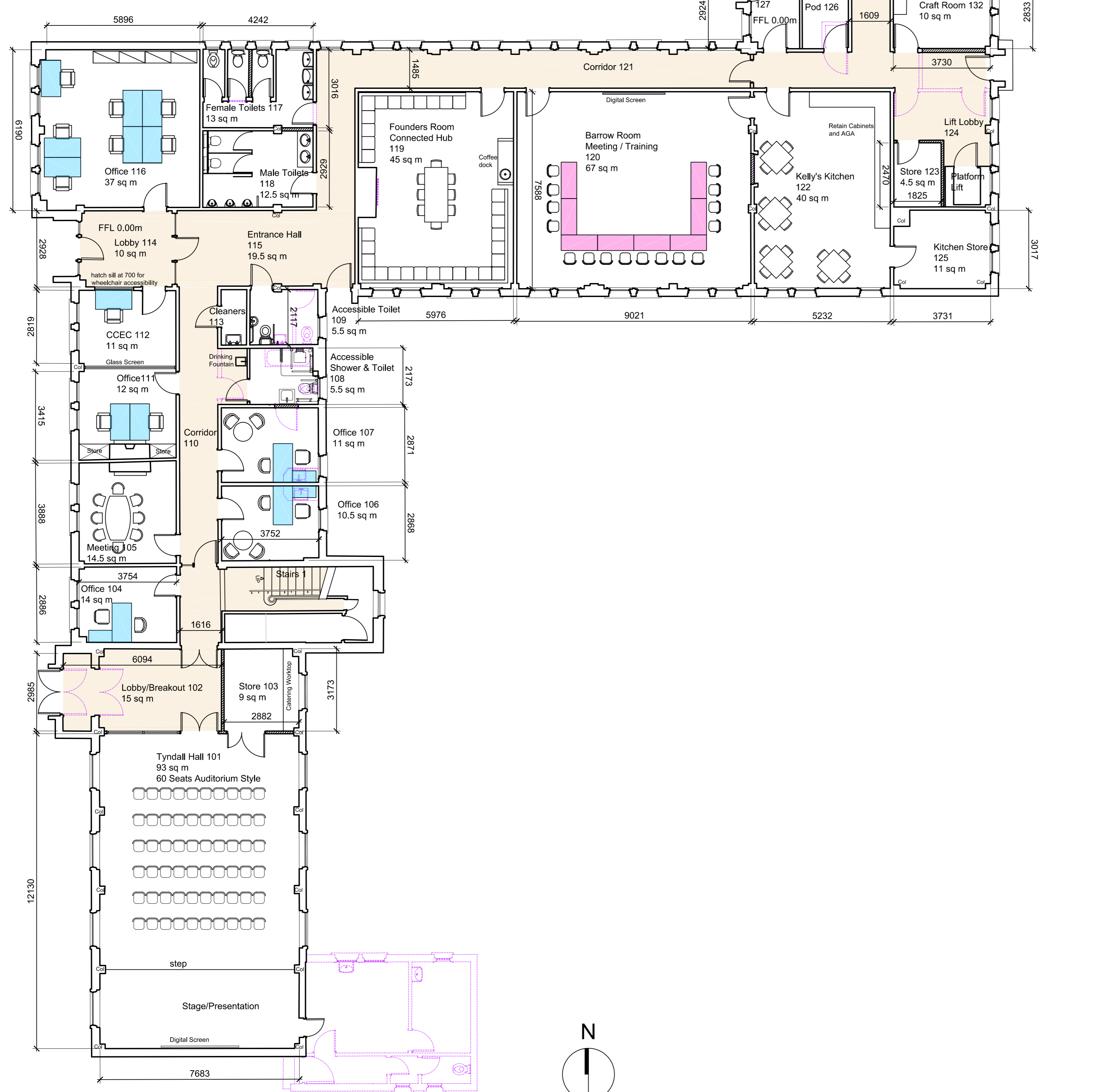

1 Proposed Ground Floor Plan showing Demolition  
1:100

**Wall Type Schedule**

	Existing wall to be retained
	New Wall
	Wall to be demolished

**Estimate of Building Occupancy**

	Ground Floor	First Floor	Total
Office Desks	14	47	61
Founders Room / Connected Hub	30		30
Barrow Room / Meeting / Training	20		20
Tyndall Hall / Auditorium	60		60
Office Visitors	5		5
<b>Total</b>			<b>176</b>

Note: Calculations assume 100% occupancy. For purposes of no. of toilets required we propose to use an occupancy of 120 persons. 60 Male and 60 Female  
 Toilet Requirements as per BS Standard 6465-1 2006  
 Male Toilets - 3 WCs, 3 WHBs, 2 Urinals  
 Female Toilets - 5 WCs, 5 WHBs

**Toilets**

	Ground Floor	First Floor	Total
Accessible Toilet	1	1	2
Accessible Toilet w/ Accessible Shower	1		1
<b>Male Toilets</b>			
WHB's	2	2	4
WC's	2	2	4
Urinals	3	2	5
<b>Female Toilets</b>			
WHB's	3	2	5
WC's	3	2	5

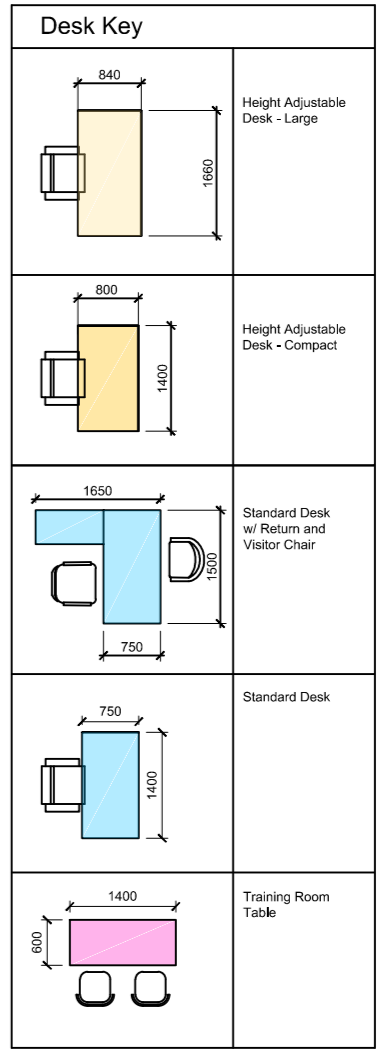

**Project Managers**  
**Quantity Surveyors**  
**Construction Cost Consultants**  
 Grove House, Athy Road,  
 Carlow, Ireland, R93 PF76.  
 Tel: +353 (0)59 913 0722  
 Email: info@brennassociates.ie  
 Web: www.brennassociates.ie  
**Brennan Associates**



Rev	Description	Date
B	Issued to CCC and Design Team Toilet Schedule Added Estimate of Building Occupancy Added/ Room Numbers Revised	13.03.2023
A	Issued for Discussion -CCC	08.03.2023



**Sketch Design**

Client: **Carlow County Council**  
 Project: **Proposed Community Enterprise Centre, Bagnelstown**  
 Title: **Proposed Floor Plans**  
 Date: 02.03.2023 Scale: 1:100 @ A1  
 Drawn by: BO'D Title: 22-2449  
 Rev No: **A2.2 Rev B**