

LAND REGISTRY COMPLIANT MAP.

673024.3158

DERELICT SITES ACT 1990.

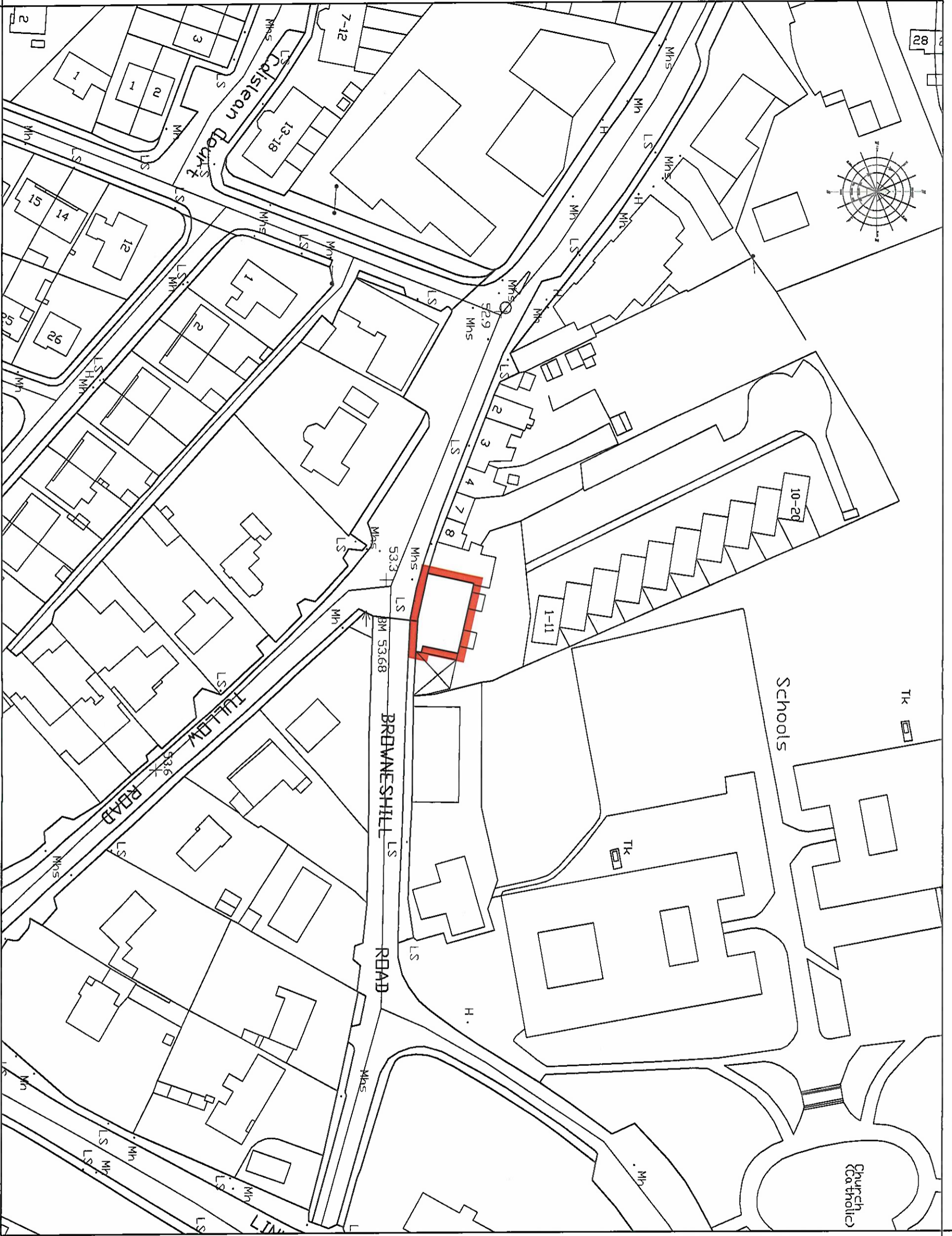

676711.1839

673339.6184

LAND REGISTRY COMPLIANT MAP.

NOTES

1. This drawing is the property of Carlow County Council. It is a confidential document and must not be copied, used, or its content divulged without prior written consent.
2. DO NOT SCALE. Use figured dimensions only, if in doubt ask.

SITE COLOURED RED 
 AREA OF SITE = 223 M² (0.0223HA)

THE OFFICIAL SEAL OF
 CARLOW COUNTY COUNCIL

WAS AFFIXED HERE TO

THIS 11th DAY OF April 2024

IN THE PRESENCE OF:

CHIEF EXECUTIVE

NOMINATED MEMBER

TOWN REGENERATION OFFICER

Nicola Lawler



Produced by Carlow County Council under
 copyright agreement from National Mapping
 Division, Tullie Eireann CYAL50326305



CARLOW COUNTY
 COUNCIL
 REGENERATION SECTION,
 County Buildings, Amy Road, Carlow
 Phone: (0509) 53265
 Email: renewal@carlowcc.ie
 Carlow Local Authorities, A CPO Accredited Company

Drawing Marked:
 Derelict Sites Act 1990
 CPODS-VHOC42-2024
 Compulsory Purchase Order.

SITE LOCATION MAP

Address: Units 2,3 & 4 Clayton Court,
 Staplestown Rd/Browmeshill Rd,
 Carlow.

(R93ED90 / R93D363 / R93VP49),
 Comprised in Folio Ref: CW222949F.

Drawn by:	P. Hughes	Job No:	CP0DS-VHOC42
Checked by:	B. Donohue	Dwg No:	CP0DS-VHOC42
Approved by:	N. Lawler	Scale:	1:1000
Date:	08/04/2024	Rev:	

676470.6141

DERELICT SITES ACT 1990.