

LAND REGISTRY COMPLIANT MAP.

671210.2237

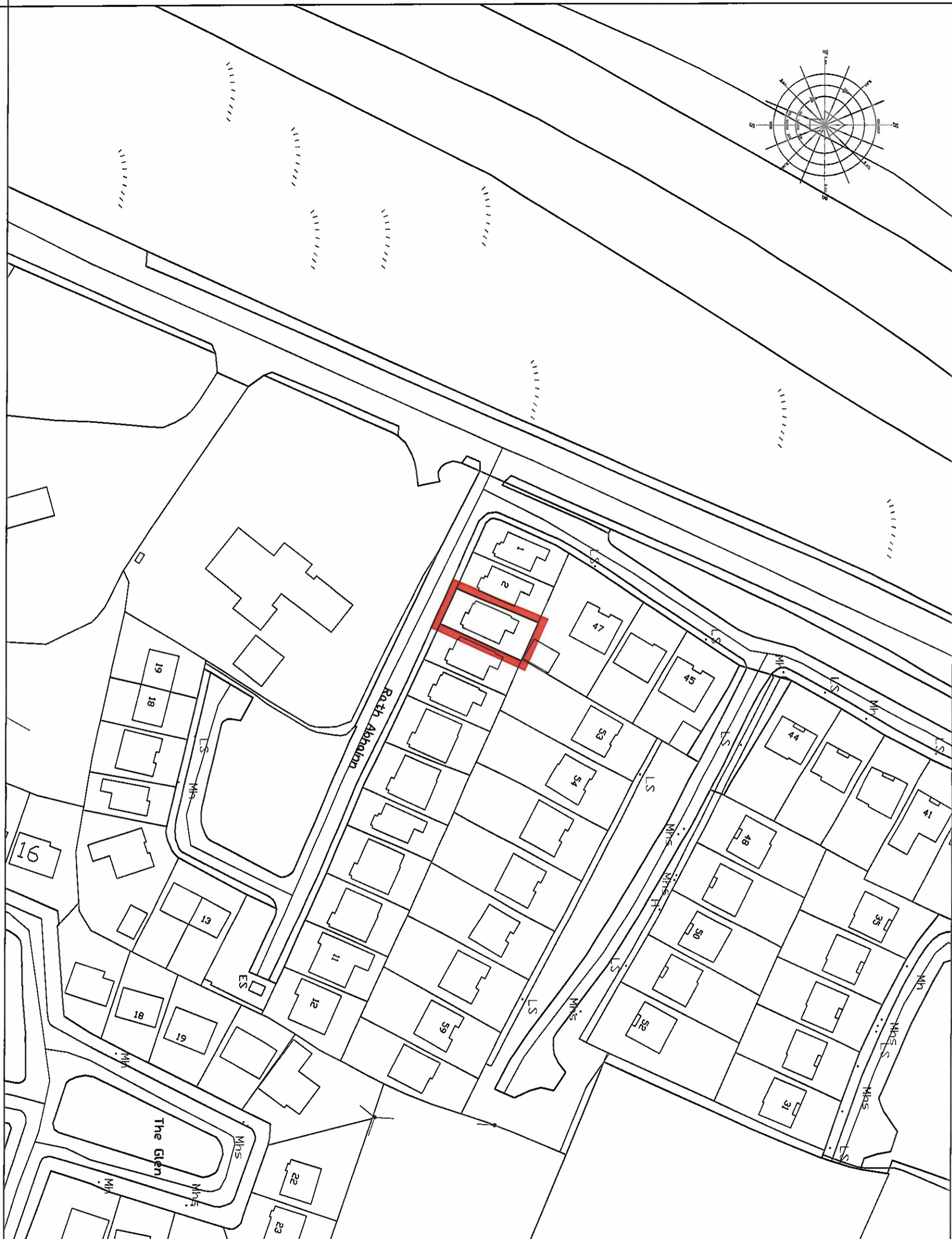
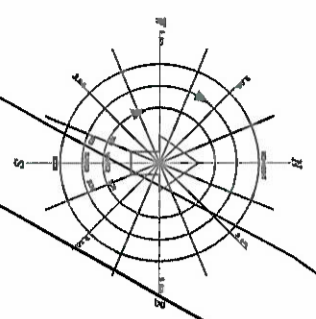

675018.4612

LAND REGISTRY COMPLIANT MAP.

LAND REGISTRY COMPLIANT MAP.

675259.0916

671525.9972

LAND REGISTRY COMPLIANT MAP.

NOTES

1. This drawing is the property of Carlow County Council. It is a confidential document and not to be copied, used, or its content divulged without prior written consent.
2. DO NOT SCALE: Use figured dimensions only, if in doubt ask.

SITE OUTLINED RED
AREA OF SITE = 233 M2 / 0.0233 HA

THE OFFICIAL SEAL OF
CARLOW COUNTY COUNCIL

WAS AFFIXED HERE TO
THIS 6th DAY OF March 2024

IN THE PRESENCE OF:
 CHIEF EXECUTIVE: *Carla O'R*
 NOMINATED MEMBER: *Alexandra Brown*
 DIRECTOR OF SERVICES: *[Signature]*



Produced by Carlow County Council under copy under copyright agreement from Ordnance Survey of Ireland all rights reserved, licence number 2023/OSI_NMA_025



CARLOW COUNTY COUNCIL
TOWN CENTRE FIRST SECTION
Director of Services Michael Foley
County Buildings, Ash Road, Carlow
Phone: (059) 132865
Email: websites@carlowco.ie

Carlow Local Authorities, A Crp Accredited Company
 CARLOW COUNTY COUNCIL,
 NO. CPD05-VH0258-2024 Carlow,
 Compulsory Purchase Order,
 Deposited Map 2024

The: SITE LOCATION.
 LAND REGISTRY COMPLIANT MAP.

Address:
 No. 3 Rath Abhainn,
 Kilkenny Road,
 Carlow.

Drawn by:	P. Hughes	Job No.:	CPD05-VH0258
Checked by:	B. Dowling	Drawn Loc.:	VH0258
Approved by:	N. Lawlor	Drawn No.:	CPD05-VH0258
Scale:	1:1000	Rev.:	
Date:	01/03/2024		