

DERELICT SITES ACT 1990.

662162.7911

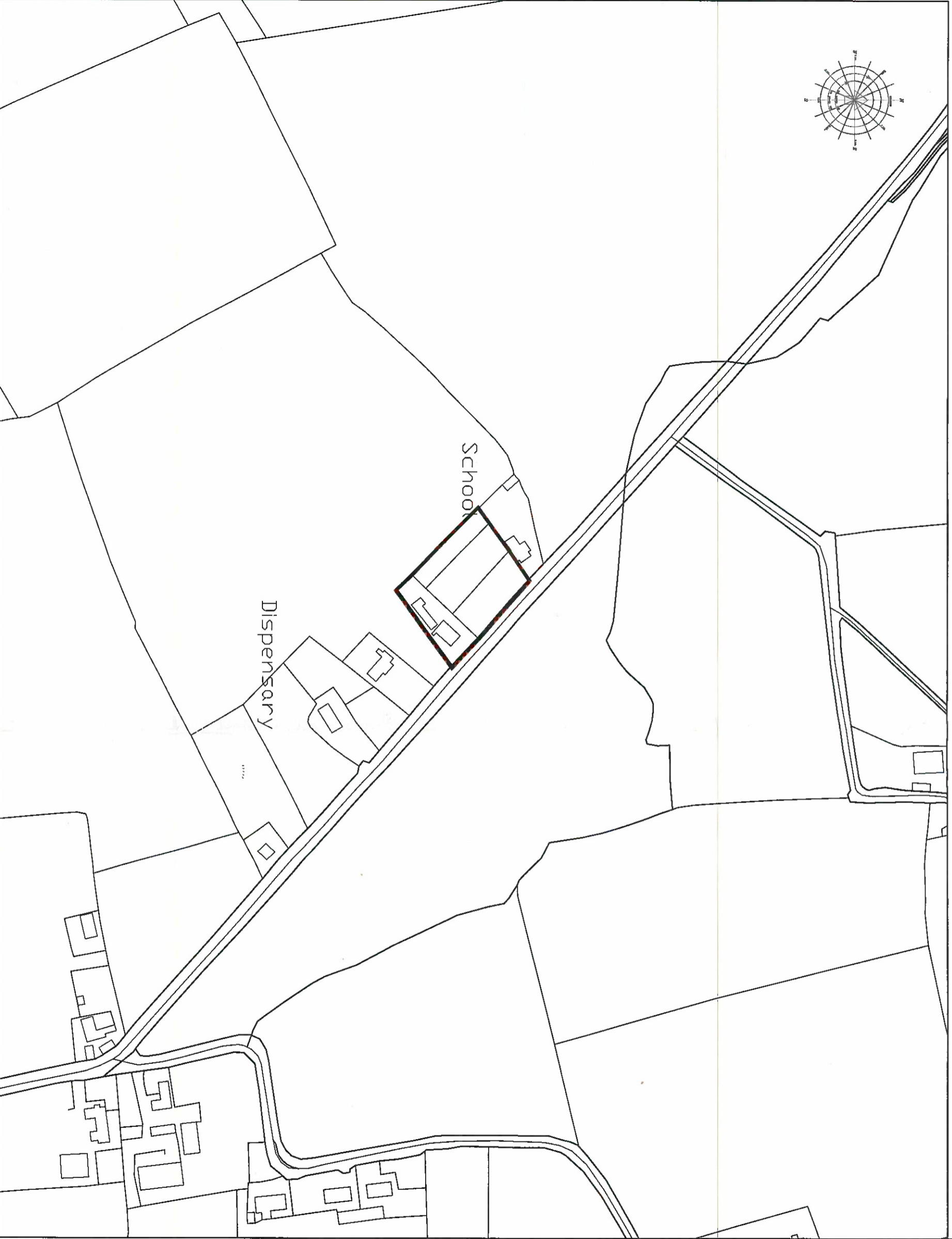
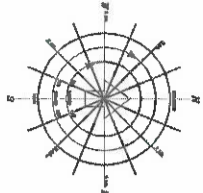

LAND REGISTRY COMPLIANT MAP.

680670.6998

LAND REGISTRY COMPLIANT MAP.

681461.0620

NOTES

1. This drawing is the property of Carlow County Council. It is a confidential document and must not be copied, used, or its content divulged without prior written consent.
2. DO NOT SCALE: Use figured dimensions only if in doubt etc.

SITE COLOURED RED
 AREA OF SITE = 4099 M2 (0.4099HA)



THE OFFICIAL SEAL OF
 CARLOW COUNTY COUNCIL

WAS AFFIXED HERE TO
 THIS 14th DAY OF November 2023

IN THE PRESENCE OF:
Carla O'V
 CHIEF EXECUTIVE
Nicola Pender
 NOMINATED MEMBER
 TOWN REGENERATION OFFICER.



Produced by Carlow County Council under
 copyright agreement from National Mapping
 Division, Tallie Eircann CYAL50326305



CARLOW COUNTY COUNCIL
 TOWN CENTRE FIRST SECTION

Director of Services/Michael Reilly
 County Buildings, Ashy Road, Carlow
 Phone: (051)913285
 Email: michael.reilly@carlowco.ie

Carlow Local Authorities, A CPD Accredited Company

Drawing Method:
 Derelict Sites Act 1990
 Compulsory Purchase Order:

CPO-DS-VH0266-2023

Site Location Map

Address:
 Property at Shangarry (R21YX52),
 Myshall,
 Co. Carlow.

(as contained within folio ref CW8249F)

Drawn By:	P. Hughes	Job No:	CPO-DS-VH0266-2023
Checked By:	B. Dwyer	Drawn Loc:	VH0266
Approved By:	N. Lender	Doc No:	CPO-DS-VH0266
Scale:	1:2500	Rev:	
Date:	07/11/2023		

661558.9882

DERELICT SITES ACT 1990.