

- NOTES**
1. FIGURED DIMENSIONS ONLY TO BE TAKEN FROM THIS DRAWING
 2. ALL LEVELS SHOWN RELATE TO ORDNANCE SURVEY DATUM AT MALIN HEAD

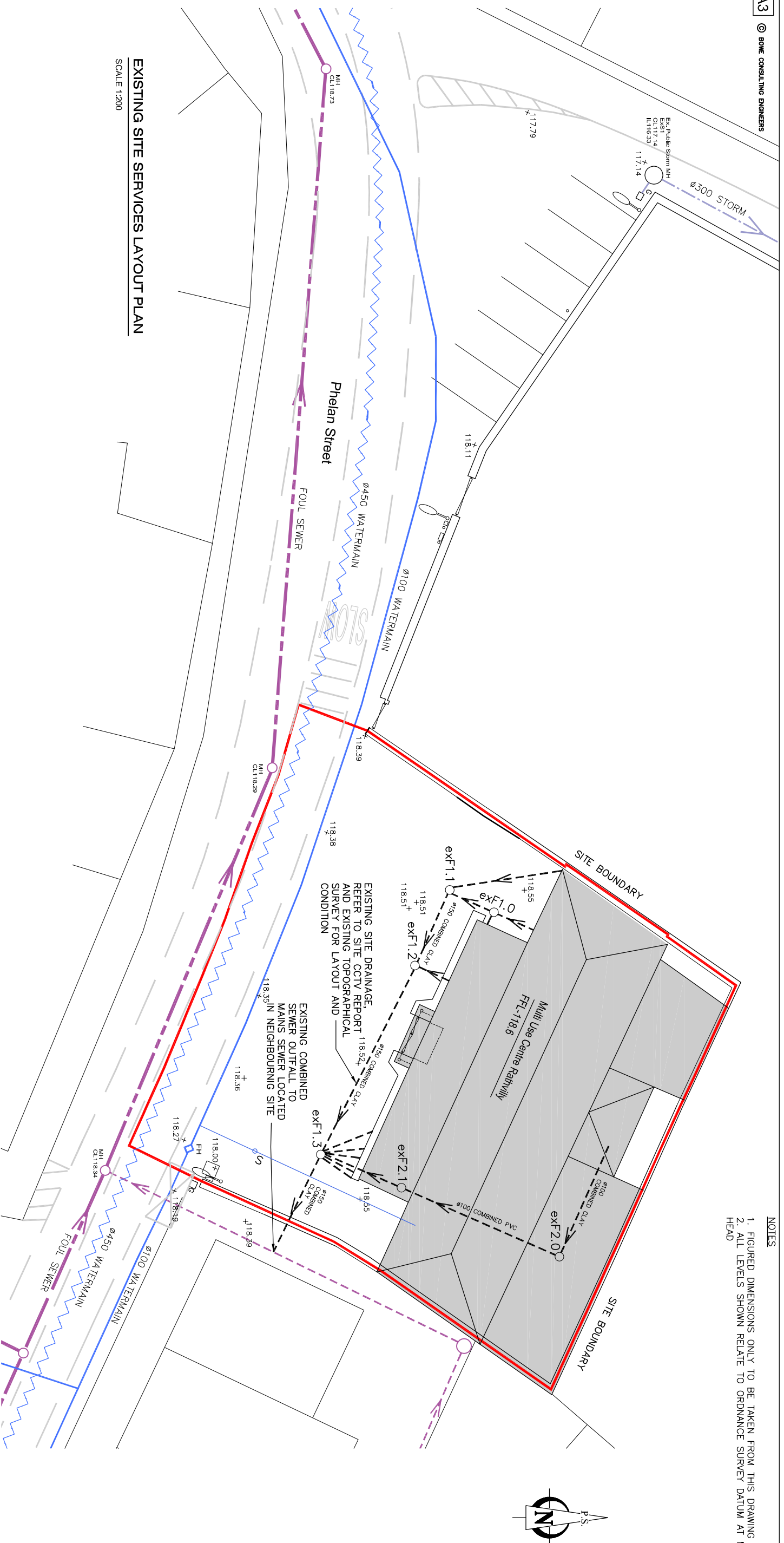

EXISTING SITE SERVICES LAYOUT PLAN
SCALE 1:200

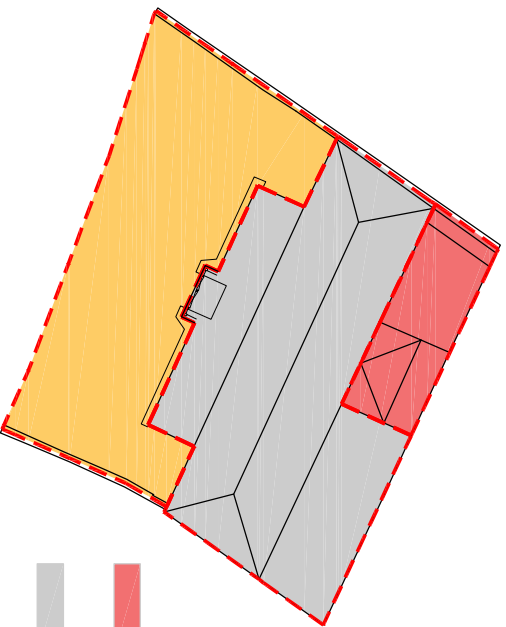

EXISTING HARDSTANDING KEY PLAN
SCALE 1:500

Legend:

- SITE BOUNDARY
- ±18.51 EXISTING SPOT LEVEL
- - - EXISTING ON SITE COMBINED DRAINAGE
- - - EXISTING 915mm WATERMAIN
- - - EXISTING 915mm WATERMAIN AND 115mm
- S EXISTING 915mm WATERMAIN AND 115mm
- - - EXISTING WATER CONNECTION FEED PIPE AND STOPCOCK
- - - EXISTING PUBLIC SEWER
- - - EXISTING PUBLIC STORM DRAINAGE

Existing Drainage

MANHOLE	PIPE Ø	Cover
exF1.0-exF1.1	100	0.520
exF1.1-exF1.2	150	0.660
exF1.2-exF1.3	150	0.750
exF1.3-Main	150	0.860
EXS1.1-EXS1.2	100	0.900
EXS1.2-TANK	100	0.870
MANHOLE CL	TL	
exF1.0	118.55	118.03
exF1.1	118.49	117.83
exF1.2	118.54	117.79
exF1.3	118.51	117.65
main	118.39	117.49
exF2.0	118.60	117.73
exF2.1	118.60	117.95

Issue register

Rev.	Date	Description	Des.	Chk.	Appr.
30.01.23		Part 8 Submission	AD	IB	

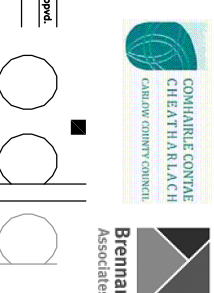

Client: CARLOW COUNTY COUNCIL	
Job Description: THE SCHOOL HOUSE COMMUNITY AND ENTERPRISE CENTRE, RATHVILLY, Co. CARLOW	
Project No: 22P1544	Drawing Ref: P01
Drawing Title: EXISTING SITE SERVICES LAYOUT PLAN	
Date: 30.01.2023	Scale: 1:250 @A3
Drawn By: AD	Checked By: IB

Bowe Consulting Engineers

(089) 9137422 www.bowe.ie info@bowe.ie
Carlow Enterprise and Enterprise Centre
Anny Road, Carlow